

GREAT NEIGHBORHOODS



Review of Full Draft Plans

Thara Johnson, Planning Director

Teun Deuling, Senior Planner

Community Development Department

June 11, 2025



Direction

Review staff recommended policies for the Crossroads and Newport neighborhood area plans.

Provide direction to schedule separate public hearings on July 9th.



Agenda

1. Background
2. Community Engagement
3. Neighborhood Area Plans: Overview
4. Addressing Existing Subarea Plans
5. Crossroads: Proposed Policies
6. Newport: Proposed Policies
7. Planning Commission Review

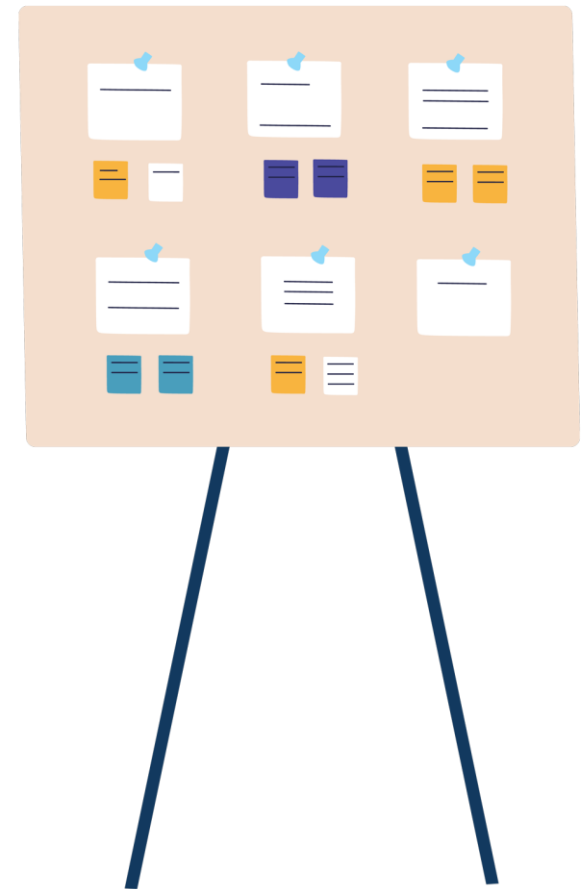

Program Objectives

1. Localize **citywide policies** that reflect **neighborhood priorities** through extensive **community engagement**
2. Develop **local policies** to address **issues and opportunities** to help the community **grow in a unique way**



Community Engagement

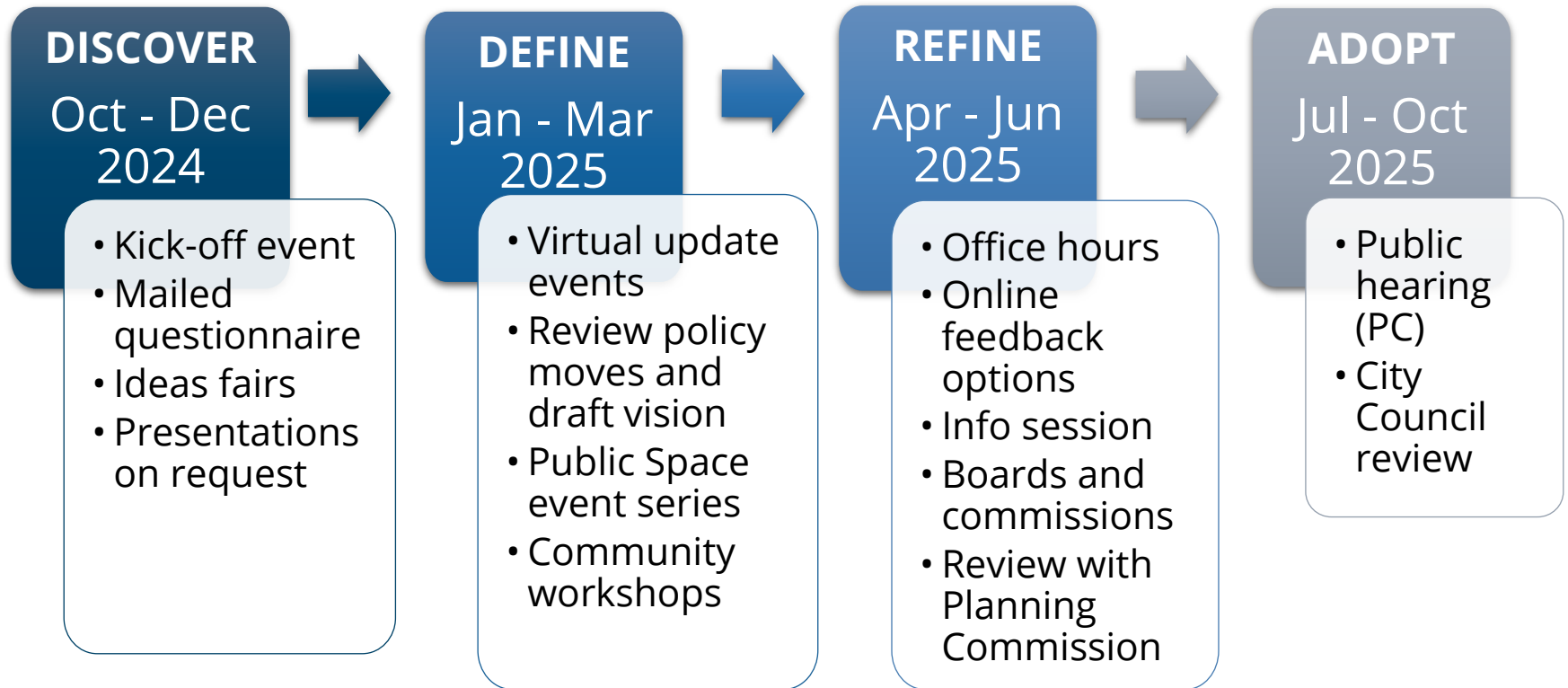

Community Engagement Strategy

Diverse Engagement

- Community clubs, HOAs and neighbors' groups
- Varied activities across the neighborhood areas
- Targeted outreach to diverse communities
- Collaborate with property managers, also KCHA
- In-person activities with seniors and school kids



Community Engagement Strategy

Broad Participation. Since launch, staff connected with:

- **841** people at in-person activities
- **1,082** visitors to online engagement hub
- **458** respondents to mailed questionnaire



Our Engagement Report provides a full summary of and is included in the meeting packet.

Neighborhood Area Plans

The draft plans are organized into five elements:

- **Neighborhood Identity** (covers land use policy)
- **Neighborhood Center(s) and Mixed Use Center**
(Crossroads only)
- **Community Gathering Spaces**
- **Mobility and Access**
- **Environment**

Neighborhood Area Plans

The draft plans include:

- **Vision statement**
- **Community context**, including its history and demographic profile
- **Policy summary** for each plan element
- **Concept maps** illustrating the urban design framework for enhancing gathering spaces and neighborhood connectivity
- Overarching **goal and policies** for each element

Urban Design Framework

The framework for enhancing **neighborhood connectivity** and **gathering spaces** entails potential design strategies as:

- Illustrated conceptually by the concept maps, and
- Supported by neighborhood plan policies.

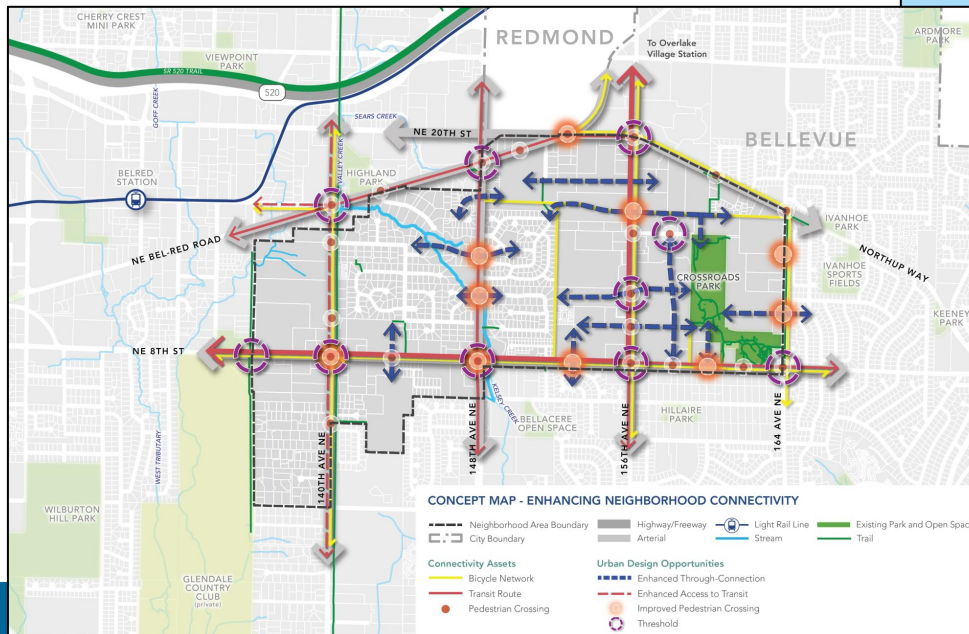

Crossroads: Existing Subarea Plans

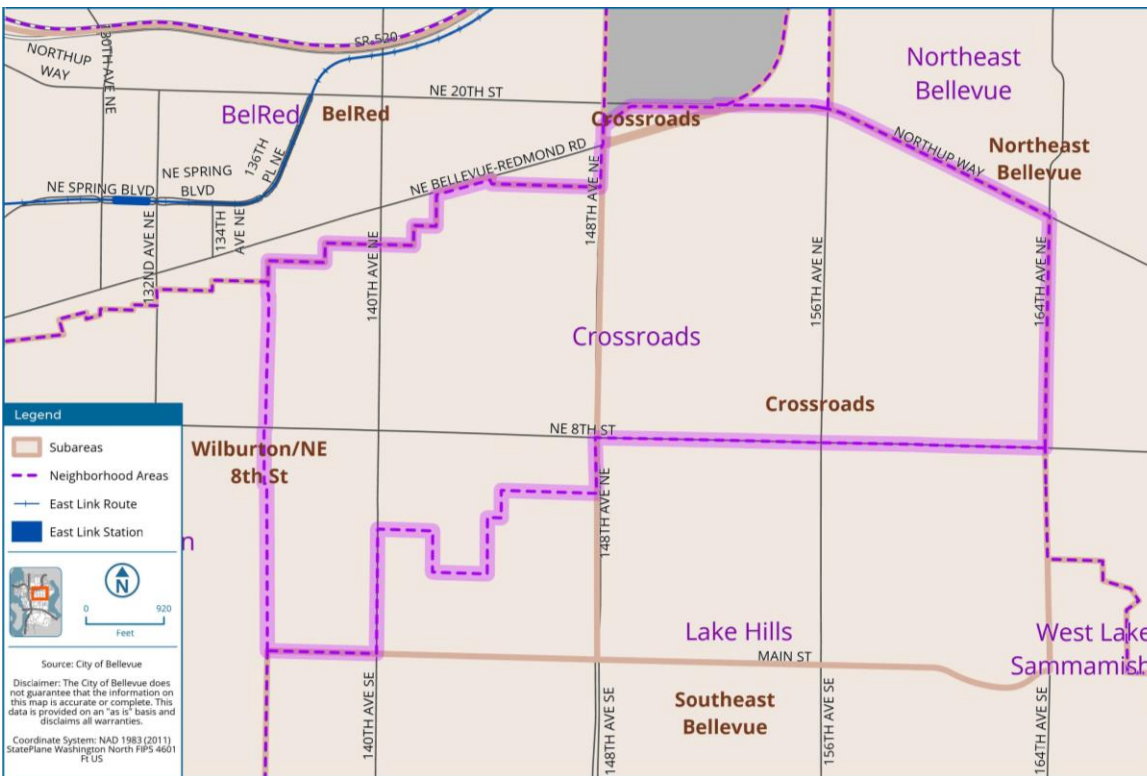

- Modify the boundaries of the BelRed and Wilburton/NE 8th Street subarea plans to align with the boundaries of the new Crossroads plan.
- Repeal the Crossroads subarea plan.
- Readopt the Crossroads subarea plan for the portion located in the Lake Hills neighborhood area. Policies that only apply to areas covered by the new Crossroads plan are removed to ensure conformance.

Newport: Existing Subarea Plans



- Modify the boundaries of the Facteria subarea plan to align with the boundaries of the new neighborhood area plan for Newport.
- Repeal the Newport Hills subarea plan.

Crossroads: Proposed Policies

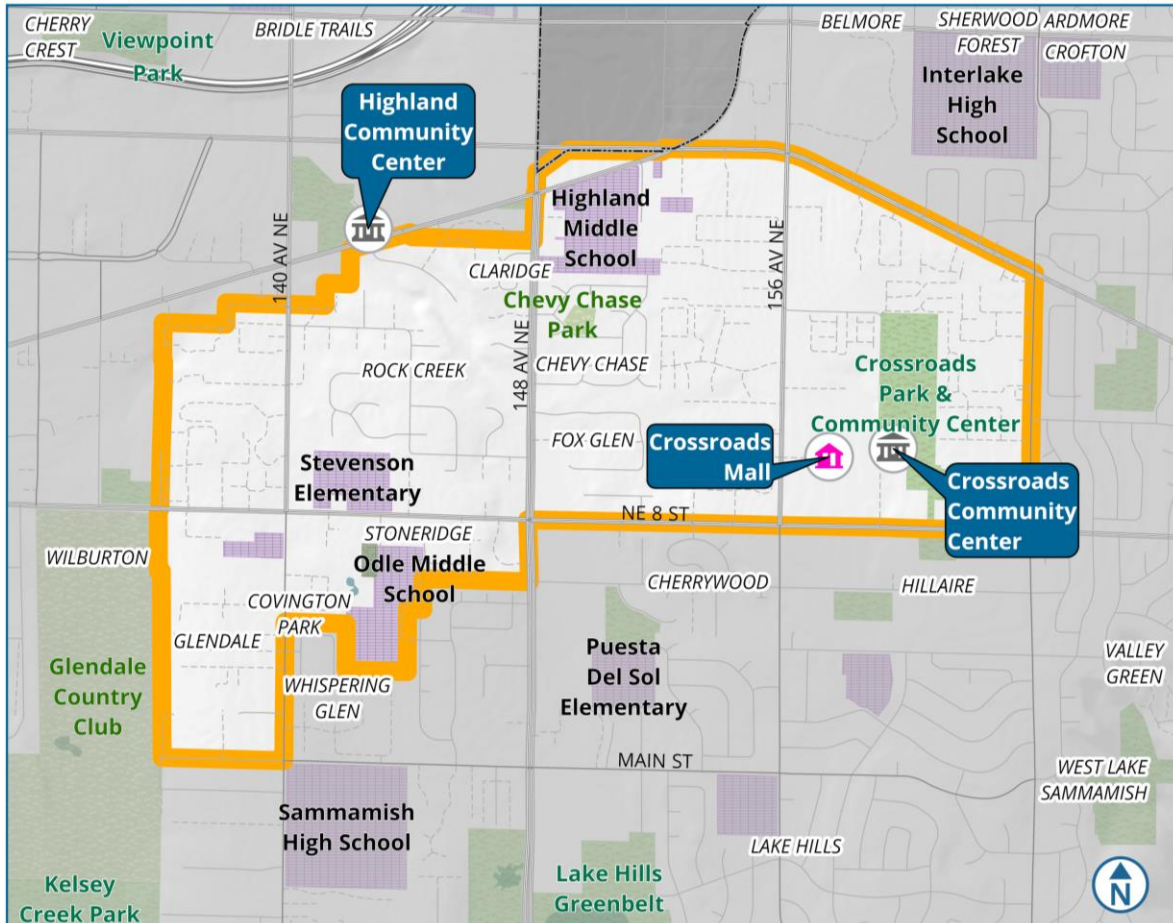

Crossroads: Proposed Policies

- **Neighborhood Identity:** Value and enhance Crossroads' distinct qualities as a diverse, vibrant and inclusive neighborhood with convenient access.
 - Create public spaces to reflect the community, improved pedestrian experience (wayfinding and accessible signage).
 - Support a future business district organization, small business retention and affordable commercial space.
 - Support permanent income-restricted housing and housing for older adults.



Crossroads: Proposed Policies

- **Neighborhood Centers and Mixed Use Center:** Support compact, livable and walkable mixed use areas.
 - Support growth and investment, also to expand (affordable) housing options.
 - Encourage a mix of uses, improve walkability, enhance cultural opportunities.
- **Community Gathering Places:** Provide a variety of welcoming gathering places throughout Crossroads
 - Add parks in underserved areas, partner to enhance and add community gathering places.



Crossroads: Proposed Policies

- **Mobility and Access:** Improve active transportation access and expand mobility options.
 - Accessible design and wayfinding, improve pedestrian connections, traffic calming, and expanded transit access (e.g., to light rail).
- **Environment:** Build a healthy and resilient community that embraces its natural qualities using an equity lens.
 - Access to natural areas, expanded tree cover, improved climate resilience broadly, and equitable access to EV charging.



Newport: Proposed Policies

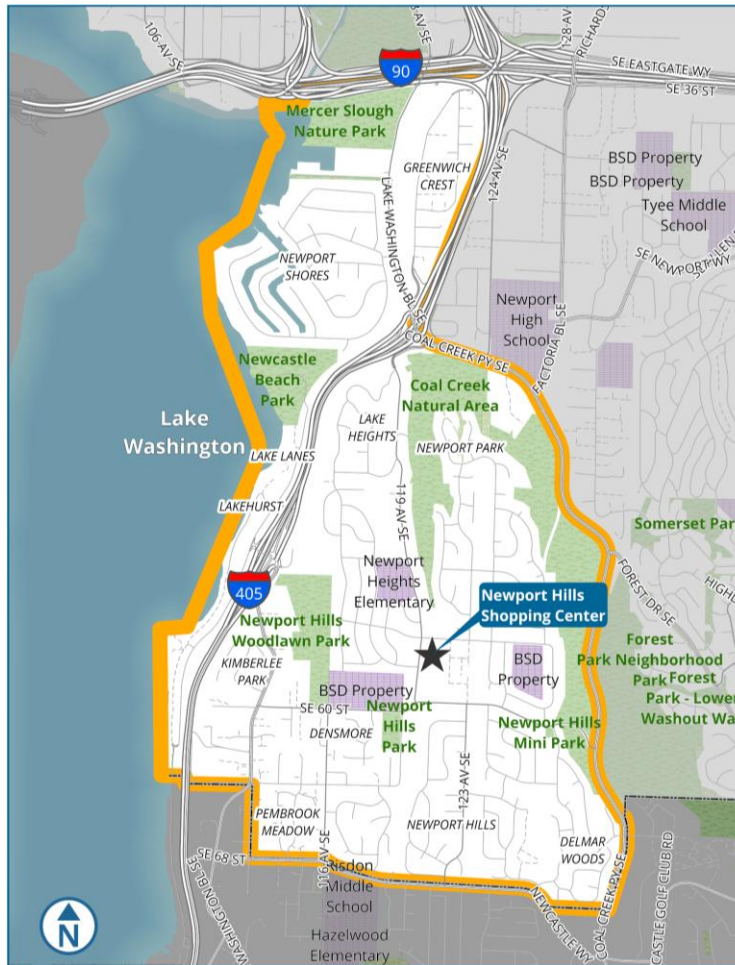

Newport: Proposed Policies

- **Neighborhood Identity:** Support a walkable community connected to natural areas and with access to local services.
 - Create public spaces to reflect the community, preserve Newport's natural beauty.
- **Neighborhood Center:** Support the continued evolution of Newport's commercial heart serving its daily needs.
 - Support walkability, encourage the retention of (small) businesses and mixed-use residential development.



Newport: Proposed Policies

- **Mobility and Access:** Meet the needs of people using all transportation modes to get around and to places beyond.
 - Develop the transportation needs to address the needs of a growing and evolving community, also through traffic calming.
 - Connect and expand the trail system, also in partnership with others, and the broader pedestrian and bicycle network.
 - Improve access and support the expansion of transit service.



Newport: Proposed Policies

- **Community Gathering Places:** Provide for the community's evolving social needs through new gathering spaces created in partnership.
 - Create (indoor) gathering places through partnerships, especially with BSD, add parks in underserved areas.
- **Environment:** Care for the many parks, trails and green areas, including wildlife habitat, in Newport.
 - Preserve and enhance wildlife habitat and water quality, improve climate resilience, and expand public water access.



Planning Commission Review

- Adoption of a neighborhood area plan follows the annual CPA process.
- CPAs are Process IV actions, meaning Planning Commission will:
 - Review the updates against the Land Use Code's Final Review Criteria.
 - Schedule public hearings for both neighborhood area plans.
 - Make a recommendation to City Council.

Direction

Review staff recommended policies for the Crossroads and Newport neighborhood area plans.

Provide direction to schedule separate public hearings on July 9th.



Appendix: Proposed Policies - Crossroads

Crossroads: Proposed Policies

Neighborhood Identity

S-CX-1	Recognize and affirm diverse heritages, histories and cultures within the Crossroads community through public art, activation and placemaking, especially efforts around play and storytelling.
S-CX-2	Explore the identification of locations and thresholds that are significant to the community and contribute to the neighborhood's identity.
S-CX-3	Integrate accessible signage and wayfinding into streetscapes and public spaces that use multiple languages and are culturally relevant to enhance accessibility and neighborhood identity.
S-CX-4	Provide aesthetic and landscaping enhancements on key corridors, including NE 8 th Street, 140 th Avenue NE, 148 th Avenue NE, 156 th Avenue NE and NE Bel-Red Road, so they become visually attractive, safe and comfortable corridors to and through the area.
S-CX-5	Provide for pedestrian amenities, including seating, lighting and trash receptacles, to promote a high-quality, attractive and safe pedestrian environment.
S-CX-6	Connect Crossroads Park with the surrounding commercial and residential areas through a safe, active and functional pedestrian environment that is integrated with the architecture, landscaping and signage of the surrounding land uses.

Crossroads: Proposed Policies

Neighborhood Identity

S-CX-7	Support the creation of a unique and well- defined identity of Crossroads' business districts through placemaking and activation.
S-CX-8	Explore the creation of a district-based organization for businesses in Crossroads to reinforce the economic vitality of the area.
S-CX-9	Encourage the retention of small businesses in Crossroads, including through increased access to affordable commercial space.
S-CX-10	Support the creation of both permanent and temporary spaces where small or emerging food businesses and vendors can develop and flourish.
S-CX-11	Support efforts to maintain both subsidized and naturally occurring affordable housing and work to preserve it as permanent income-restricted housing.
S-CX-12	Support the development of housing options for older adults and ensure nearby public places are accessible, safe and welcoming to support older adults meeting their basic needs and their ongoing involvement in the community.

Crossroads: Proposed Policies

Mixed Use Center & Neighborhood Centers

S-CX-13	Establish and sustain Crossroads' designation as a Countywide Center (see Map LU-3 of the Land Use Element) as a focal point for local and county planning and investment to support a concentration of jobs, housing, shopping, mobility options and recreational opportunities.
S-CX-14	Support development of a compact, livable and walkable mixed use center in Crossroads as an area planned for employment growth, expanded housing options and increased affordability.
S-CX-15	Encourage investment to expand housing affordability and stability while providing amenities for the community.
S-CX-16	Enhance existing Neighborhood Centers (see Map LU-2 of the Land Use Element) designed to serve neighborhoods, recognizing their multiple roles: serving residents' needs, acting as community gathering places and helping to establish neighborhood identity.
S-CX-17	Encourage a mix of residential, retail and service uses in Neighborhood Centers to promote easy pedestrian access and enhance the livability and vibrancy of the neighborhood.
S-CX-18	Encourage and enhance arts and cultural opportunities within Neighborhood Centers.

Crossroads: Proposed Policies

Community Gathering Places

S-CX-19	Acquire parcels suitable for neighborhood parks where such parcels can have active transportation access, especially west of 152 nd Avenue NE.
S-CX-20	Partner with community-based organizations, faith-based organizations and private partners to create accessible, affordable and welcoming community gathering places, especially indoors.
S-CX-21	Continue to work with private partners to foster Crossroads Shopping Center's role as a community gathering place reflective of neighborhood identity and the community's cultural diversity.
S-CX-22	Collaborate with the Bellevue School District to strengthen school sites' function in Crossroads as safe and welcoming community gathering places.

Crossroads: Proposed Policies

Mobility and Access

S-CX-23	Design city streets, shared use paths and trails recognizing the mobility needs of people of all ages and abilities.
S-CX-24	Expand mobility options and encourage the use of transit and active transportation to improve the quality of the travel experience for all users.
S-CX-25	Improve pedestrian and bicycle network facilities for access to frequent transit network stops and to nearby light rail stations, including through coordination with Redmond, consistent with the Mobility Implementation Plan.
S-CX-26	Improve the opportunities for pedestrians to safely cross arterials at signalized intersections, especially in Neighborhood Centers, and at designated mid-block locations, consistent with the Mobility Implementation Plan.

Crossroads: Proposed Policies

Mobility and Access

S-CX-27	Support the creation of pedestrian connections within superblocks, with a focus on integrating these connections into public property, and through large commercial blocks and developments.
S-CX-28	Provide signage and wayfinding to direct individuals to transit and to off-street active transportation facilities to promote and facilitate their use.
S-CX-29	Work with transit service providers to enhance transit passenger amenities at bus stops and stations.
S-CX-30	Address speeding and other traffic safety concerns through traffic calming measures that adhere to Vision Zero and Complete Streets principles.

Crossroads: Proposed Policies

Neighborhood Identity

S-CX-31	Encourage and support increased awareness and access to natural areas, especially the Kelsey Creek Basin, for their enjoyment by the community as a public amenity.
S-CX-32	Strive to increase tree canopy, using native and climate-adaptive species where feasible, in areas with lower tree canopy, especially Crossroads' commercial and mixed-use areas.
S-CX-33	Adapt public spaces to reduce vulnerability to extreme heat and extreme precipitation through increased tree canopy, climate resilience measures, and low impact development techniques.
S-CX-34	Collaborate with diverse partners on the provision of climate-friendly affordable housing that minimizes energy and resource use and that is adaptable to a changing climate, including heat, flooding, air pollution and wildfire events.
S-CX-35	Work with community-based organizations to develop community-serving facilities augmented to support community members and coordinate resource distribution and services before, during and after a hazard event.
S-CX-36	Support efforts to provide electric vehicle charging infrastructure in commercial areas and existing multifamily residential developments to advance equitable access.

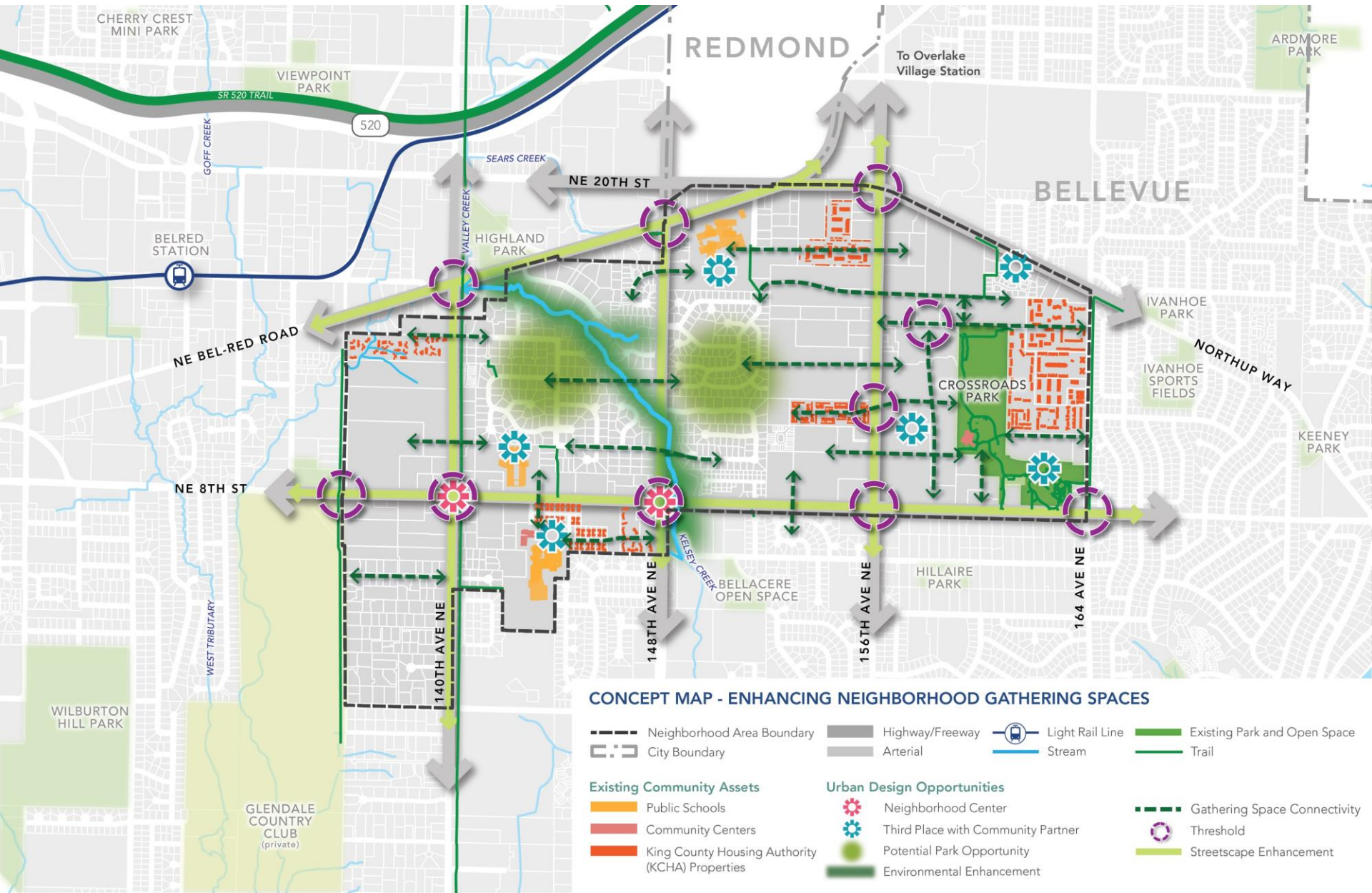

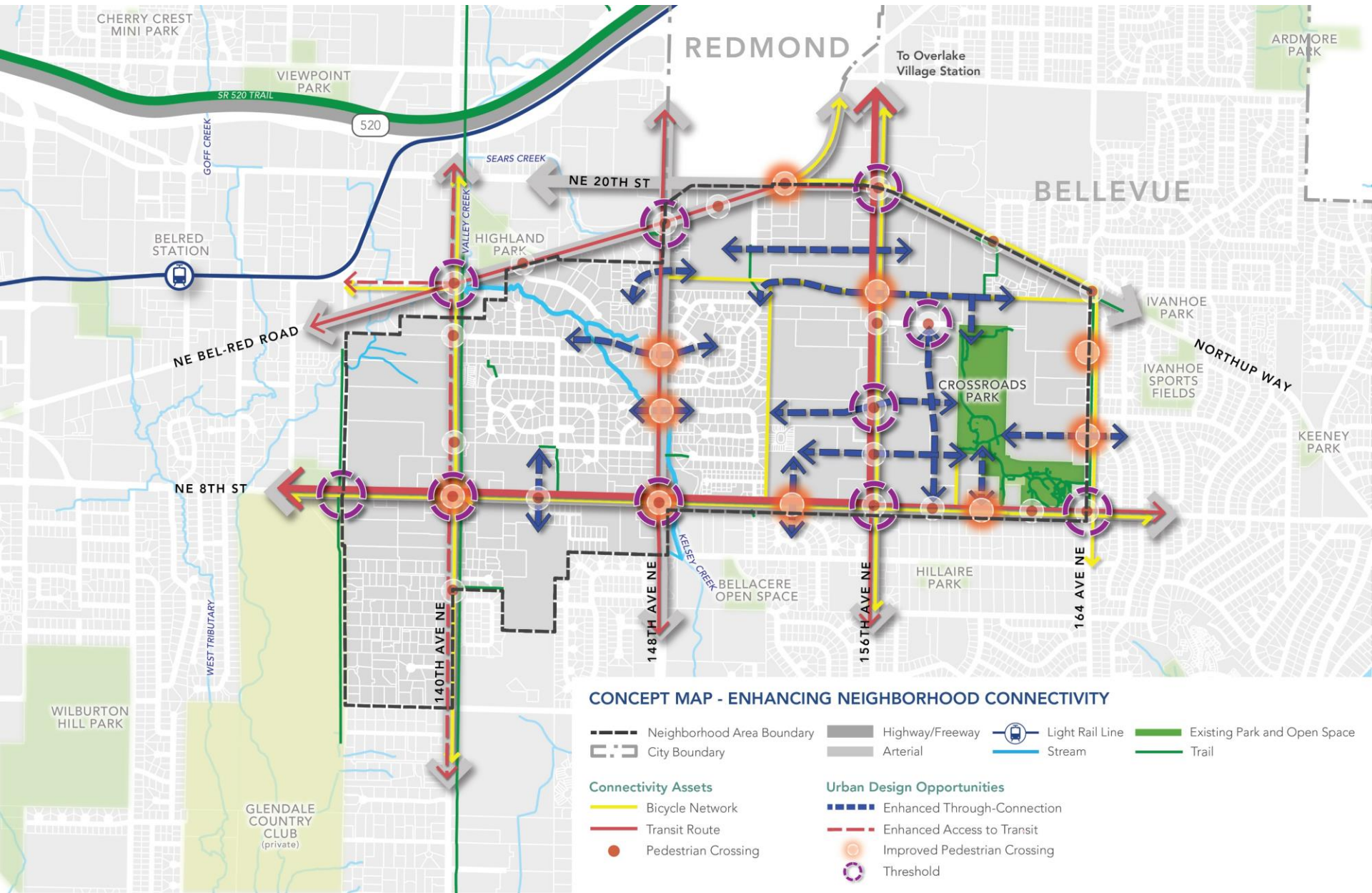

Appendix: Proposed Policies - Newport

Newport: Proposed Policies

Neighborhood Identity

S-NP-1	Support Newport's identity as a diverse and connected community, anchored by forested natural areas and connections to streams and Lake Washington.
S-NP-2	Identify locations and thresholds that are significant to community and contribute to the neighborhood's identity.
S-NP-3	Reflect the continuing contributions of many different cultures to Newport in the design of public spaces and through public art.
S-NP-4	Connect the Neighborhood Center with residential areas through a network of safe, pedestrian and bicycle facilities.
S-NP-5	Preserve existing visual features such as trees and hilltops, public views of water, and open space in new development when feasible.
S-NP-6	Strive to minimize loss of trees, especially on slopes and hilltops, mitigate unavoidable tree removal, and maintain and expand the tree canopy and forested environment in natural areas.

Newport: Proposed Policies

Neighborhood Center

S-NP-7	Support a neighborhood-serving commercial district as shown on Map LU-2 (Volume 1) Neighborhood Centers as a walkable mixed use area with multiple transportation options.
S-NP-8	Encourage new buildings to be located adjacent to the sidewalk to create an engaging street life for pedestrians in the Neighborhood Center.
S-NP-9	Encourage the inclusion of small commercial spaces to accommodate new and displaced businesses in new commercial development.
S-NP-10	Encourage the retention of businesses impacted by redevelopment in the new development.
S-NP-11	Support the unique identity of the Neighborhood Center as a center of community life and commercial activity through signage, public art and activities.
S-NP-12	Encourage the construction of multifamily housing within the Neighborhood Center.

Newport: Proposed Policies

Community Gathering Places

S-NP-13	Create accessible, affordable and welcoming indoor gathering places that support community needs and encourage intergenerational connections on City property or in partnership with organizations like schools, faith communities and social clubs.
S-NP-14	Identify locations and partners to support a community-serving facility augmented to support residents and coordinate resource distribution and services before, during and after a hazard event.
S-NP-15	Encourage the Bellevue School District to include community-serving uses, such as a community center, daycare or senior center in the redevelopment of its property and support the use of surplus Bellevue School District property as third places.
S-NP-16	Collaborate with Bellevue School District on the joint use of public property to benefit operational needs of both organizations.
S-NP-17	Support multi-functional, programmable parks and other outdoor spaces for sports, cultural activities, community gatherings, events and recreation opportunities that meet the needs of the community.
S-NP-18	Acquire parcels suitable for neighborhood parks, especially where such parcels can be connected to the trail system.

Newport: Proposed Policies

Mobility and Access

S-NP-19	Develop the transportation network to address the mobility needs of a growing and evolving community.
S-NP-20	Improve the experience of people walking, biking, rolling and taking transit through the use of greenery, trees and landscaping.
S-NP-21	Address cut-through traffic, speeding and other traffic safety concerns through traffic calming measures that adhere to Vision Zero and Complete Streets principles.
S-NP-22	Support the expansion of transit service in the neighborhood, connecting with Downtown Bellevue, light rail service and the region.
S-NP-23	Expand and connect the public trail network as land and funding become available in collaboration with other public landowners.
S-NP-24	Collaborate with King County and other managers of local trails to implement signage to help people identify entrances to and connect between trail systems
S-NP-25	Work with Newcastle and King County to connect to trail systems across jurisdictions.

Newport: Proposed Policies

Mobility and Access

S-NP-26	Work with Newcastle and King County to connect to trail systems across jurisdictions.
S-NP-27	Work with school districts to enhance trails that pass through or are adjacent to school district property and connect them to the rest of the trail system.
S-NP-28	Support the expansion and enhancement of the pedestrian network with an emphasis on safety and connectivity.
S-NP-29	Expand and connect bicycle network facilities consistent with the Mobility Implementation Plan.
S-NP-30	Expand on- and off-street pedestrian and bicycle facilities to connect people to Eastrail safely from nearby destinations.
S-NP-31	Coordinate with WSDOT to improve the I-405 crossing at the Lake Washington Boulevard interchange to provide safer and more comfortable active transportation connections to Eastrail and Newcastle Beach Park.

Newport: Proposed Policies

Environment

S-NP-32	Work with partners to preserve and enhance the wildlife habitat in Coal Creek Park, Newport Hills Woodlawn Park, Newcastle Beach Park, Mercer Slough Nature Park and the creeks and green corridors between and adjacent to them.
S-NP-33	Expand access to Lake Washington and its tributary creeks and streams to support their ecological functions, and contribute to educational or recreational opportunities for the community.
S-NP-34	Support efforts to enhance the water quality in streams and creeks to support fish and animal life.
S-NP-35	Encourage the use of low impact development techniques in new developments and public spaces, especially in areas with significant impervious surface coverage, to minimize flooding and contamination of Coal Creek and other neighborhood streams to support human, fish and wildlife health.
S-NP-36	Add information signage throughout the neighborhood about the history of the region, the natural areas, the animal habitat, and how people can contribute to the health of the environment.
S-NP-37	Collaborate with King County and King County Conservation District to prepare the neighborhood and its natural areas in the wildland-urban interface to be resilient against brush fires and wildfires.

CONCEPT MAP - ENHANCING NEIGHBORHOOD GATHERING SPACES

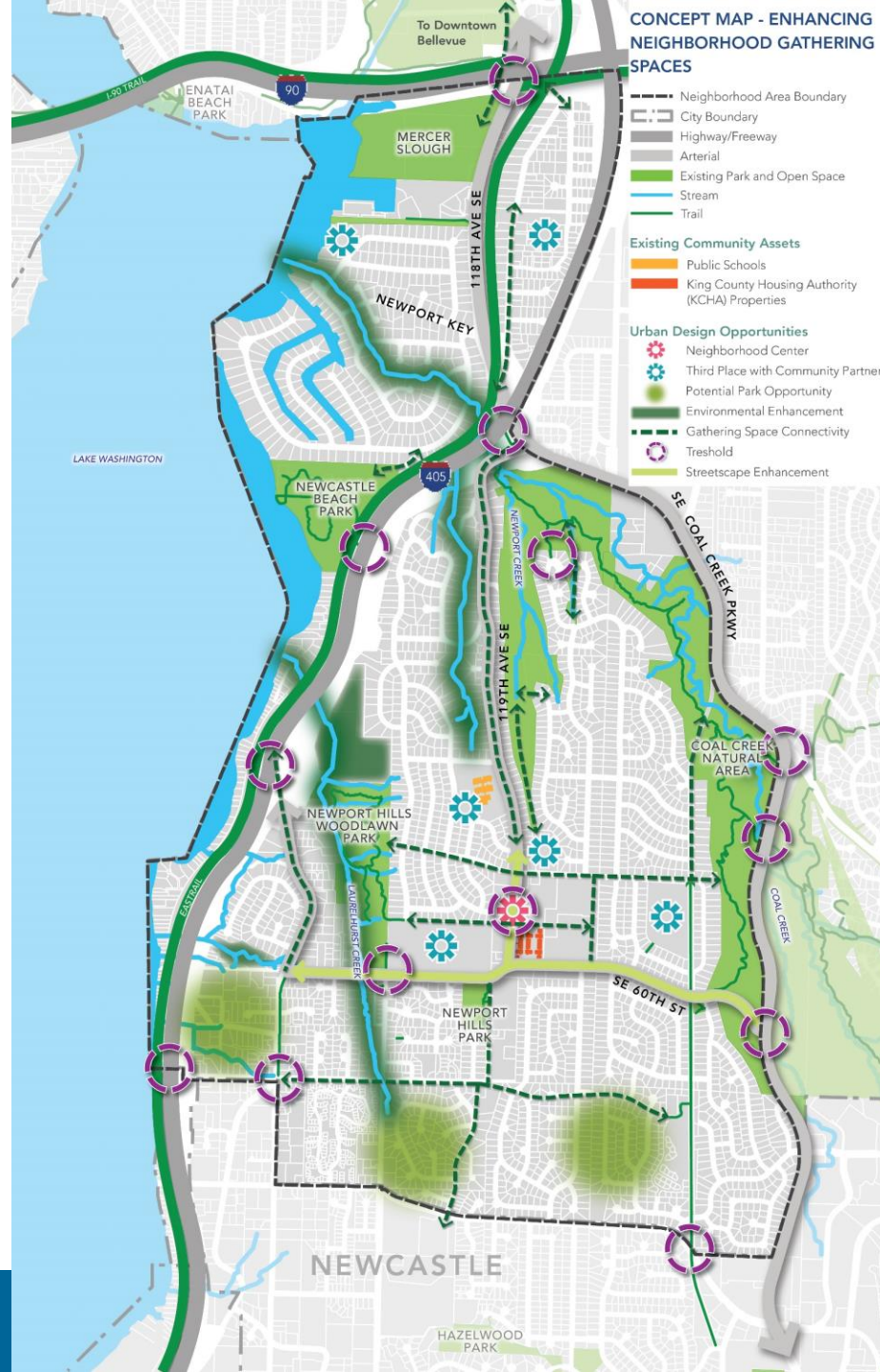

CONCEPT MAP - ENHANCING NEIGHBORHOOD CONNECTIVITY

