

Proposal to Include Dedicated Pickleball Courts in the Development of Bellevue Airfield Park

June 2022

Background

- Responding to community input*, Bellevue Parks & Open Space System Plan (2022) has included the need for more pickleball courts in Bellevue
- Two-prong approach*:
 - Near-term solution
 - Convert some existing tennis courts to dual-use courts shared between tennis and pickleball players
 - To be implemented in the near-future
 - Long-term solution
 - Develop dedicated pickleball courts in 8-court (or more) clusters
 - Potential locations of courts are not identified in the System Plan

* Court Usage Data and Dual-Usage Proposal (10-7-2021).pdf

* Implementation Dual-Usage Courts (01-25-2022).pdf

Bellevue Airfield Park

- The 27-acres park is located in the Eastgate neighborhood
- It is one of the few large undeveloped area in Bellevue
- Consists of 3 parcels (enclosed by blue line in figure) owned by Parks Department
 - Parcel 9060 - 10.5 acres
 - Parcel 9105 - 2.5 acres
 - Parcel 9123 - 14.6 acres
- Parcel 9123 is more level and easier to develop
 - Several large ball fields were proposed in the 2012 Bellevue Airfield Park Master Plan (which was not implemented)

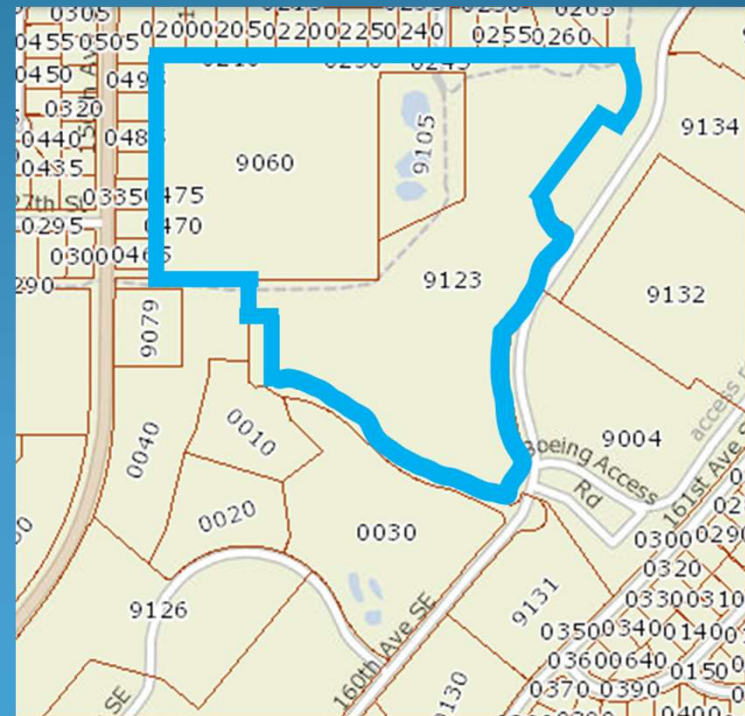

2022 Bellevue Airfield Park Master Plan

- A Master Plan update for the Bellevue Airfield Park will be written in the next few months
- It will include the development of an aquatic center and large ball fields
- We propose to include the development of 8 dedicated pickleball courts in the 2022 Airfield Park Master Plan

Rationale for Pickleball Courts in Airfield Park

- 8 dedicated pickleball courts
 - Require 1/3 acre (120 by 120 feet) (blue area in figure)
 - Occupy only 2% of Parcel 9123 (yellow area in figure) in the Park
 - Small footprint of the 8 pickleball courts (blue) relative to Parcel 9123 (yellow) is evident in the figure
- Pickleball court usage will utilize infrastructures (parking and restrooms) that are needed for the ball fields and aquatic center

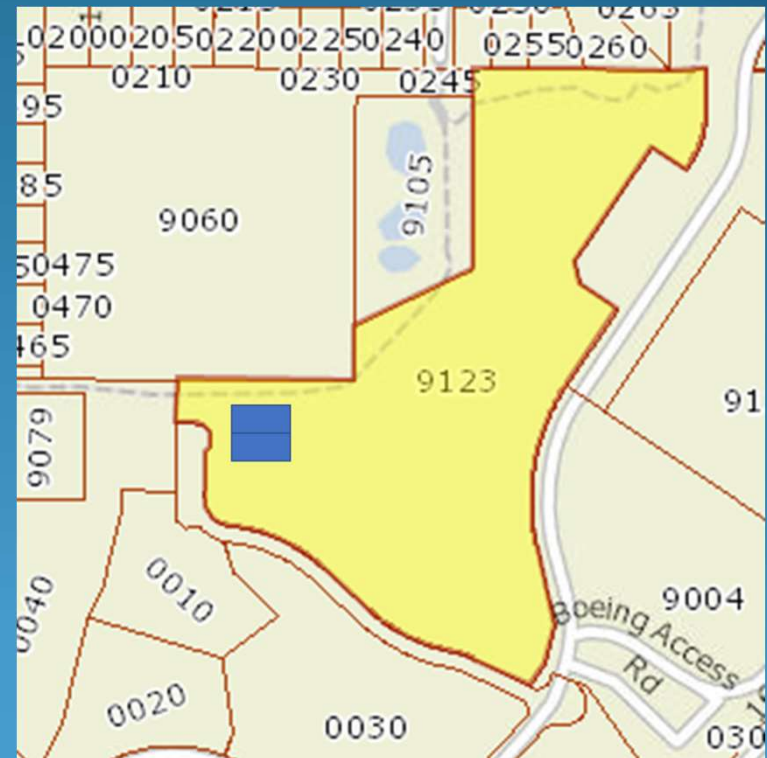

Phases of Airfield Park Development

- The multimillion dollar aquatic center will likely take many years to complete
- We propose to have pickleball courts (and maybe also the ball fields) developed in the first phase of the Airfield Park development
 - Pickleball courts are relatively inexpensive to build and maintain
 - We estimate it requires about \$300k to build 8 dedicated pickleball courts
 - They require maintenance efforts similar to tennis courts
 - Potential co-funding by Microsoft, T-Mobile, King County Parks Levy Grants and Washington State Recreation & Conservation Office
 - It might be easier to find a small piece of land that has stopped settling (the land parcel is an old landfill)
 - Completion of the courts would provide early success story for the Airfield Park development which resides in an underserved subarea in Bellevue

Contact Information

- This proposal is supported by Eastside pickleball players including many Bellevue residents
- David Lai [dlaiiocean.lai@gmail](mailto:dlaiiocean.lai@gmail.com) 425-891-4346
- Leslie Wang jl777@comcast.net
- Barbara Carey barbcarey97@comcast.net
- Lisa Tsang lisa.tsang@outlook.com
- Lynn Kaner lynnkaner@comcast.net
- Jessica Prince jgprince@hotmail.com
 - (Board member of the Seattle Metro Pickleball Association)