

# New Neighborhood Areas Mapping

# Overview

- Timely to update now
- Some boundaries are significantly out of date; not recognized geographies
- New boundaries establish a solid foundation for updating subarea plans
- Policy that applies to current boundaries remains in effect, until subarea plans are updated

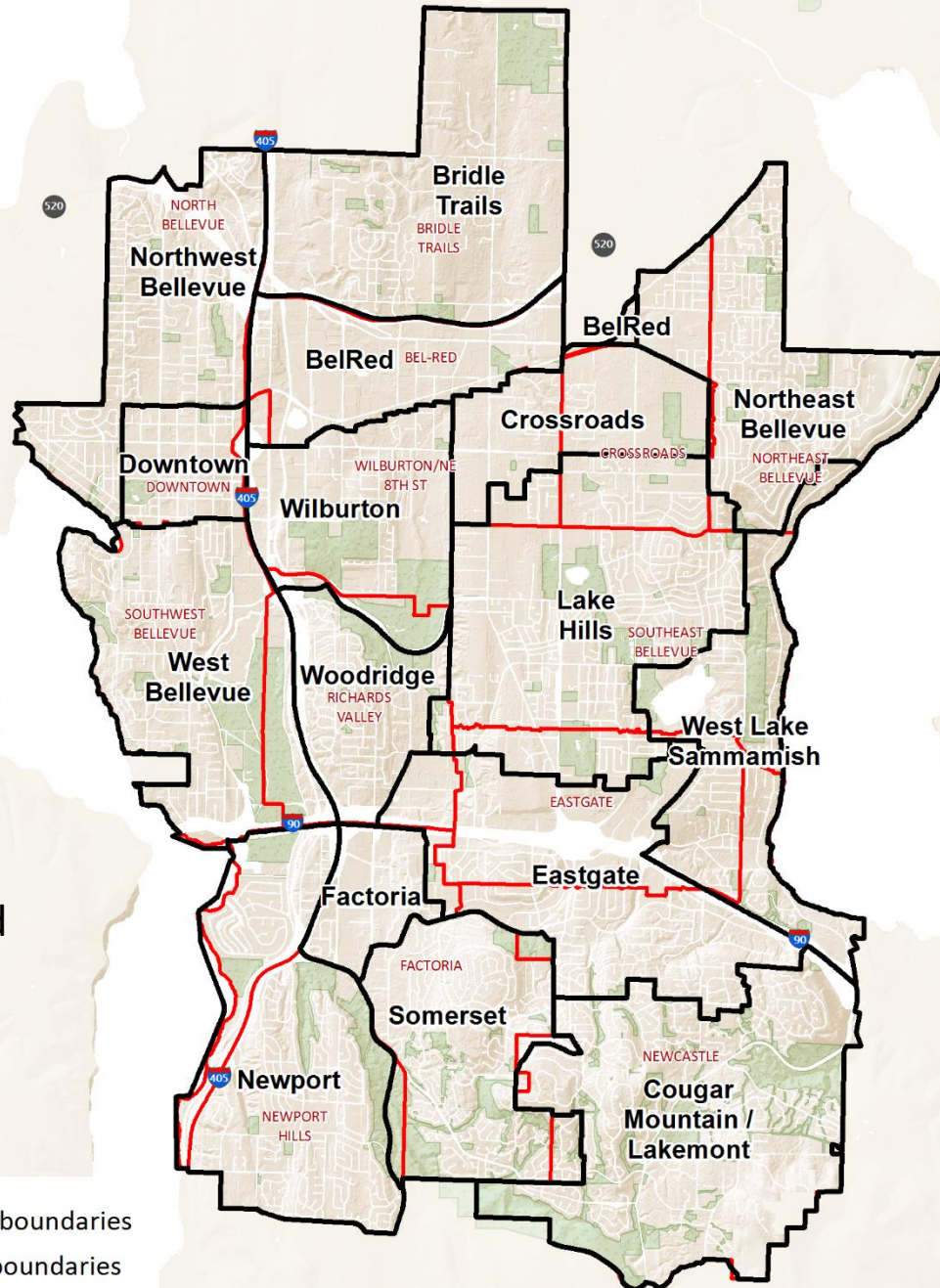
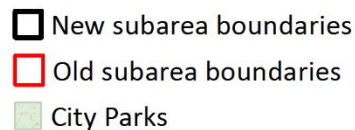

# Process & Criteria

- Better align with areas that people self identify with
- Recognition of neighborhood association boundaries
- Use of major arterials, topography and major geographical features
- Logical planning area; critical mass sufficient for subarea planning

## Neighborhood engagement

- Tested with neighborhoods over last two years
- Neighborhood Leadership meetings
- Off-site Planning Commission meetings
- Planning Commission public hearing

# Downtown and Northwest Bellevue

No change to Northwest

Change West Bellevue/Vuecrest?

East boundary aligned w/ 405 centerline

DT southern boundary changes

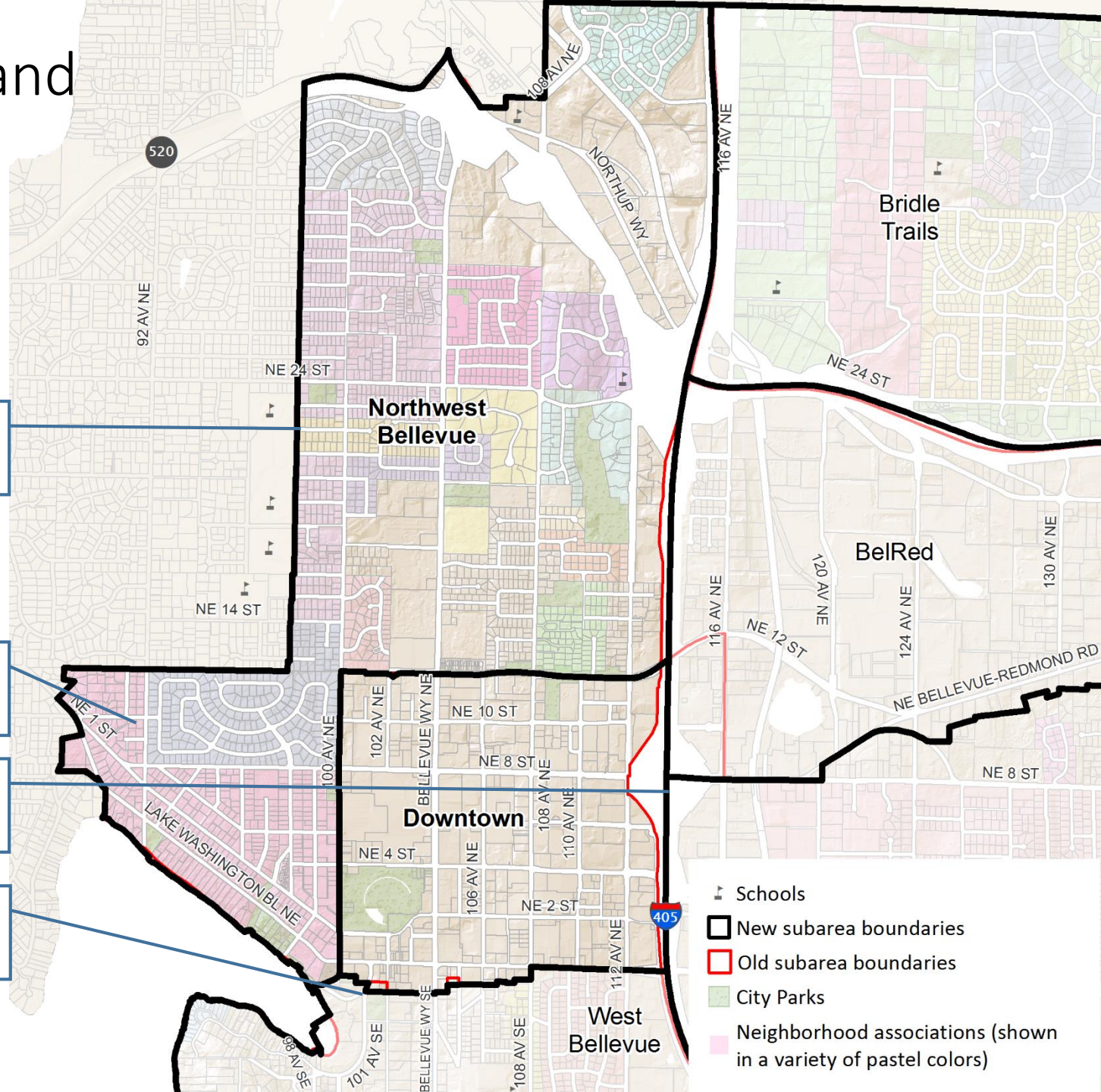

# BelRed and Wilburton

This map illustrates the proposed changes to the BelRed and Wilburton subareas. The map shows the following areas and boundaries:

- BelRed:** The central area, outlined in black, extending from NE 24 St to NE 8 St and from 116 Av NE to 148 Av NE.
- Wilburton:** The area south of BelRed, outlined in black, extending from NE 8 St to SE 8 St and from 116 Av SE to 140 Pl SE.
- Neighboring Areas:** Northwest Bellevue, Downtown, Crossroads, Lake Hills, Woodridge, and West Bellevue.
- Boundaries:** New subarea boundaries are shown in black, and old subarea boundaries are shown in red.
- Callouts:**
  - Removed hyphen from BelRed place name
  - Medical District moved to BelRed with NE 8<sup>th</sup> Street as boundary
  - Lake Hills Connector made southern boundary of Wilburton
  - Golf course/ 136th Ave E used as east boundary
- Legend:**
  - Schools (indicated by a school icon)
  - New subarea boundaries (black line)
  - Old subarea boundaries (red line)
  - Neighborhood associations (shown in a variety of pastel colors)

## Lake Hills Connector made southern boundary of Wilburton

## Wilburton

Golf course/ 136th Ave E  
used as east boundary

Lake Hills

Neighborhood associations (shown in a variety of pastel colors)

# Crossroads, Northeast Bellevue & Lake Hills

Interlake and Sherwood Forest included in NE Bellevue

Maintains 156<sup>th</sup> Ave as BelRed/NE boundary as reviewed by Planning Commission

Chevy Chase, Fox Glen and Rock Creek included in Crossroads

Neighborhood association and elementary school boundaries followed for southern Crossroads boundary

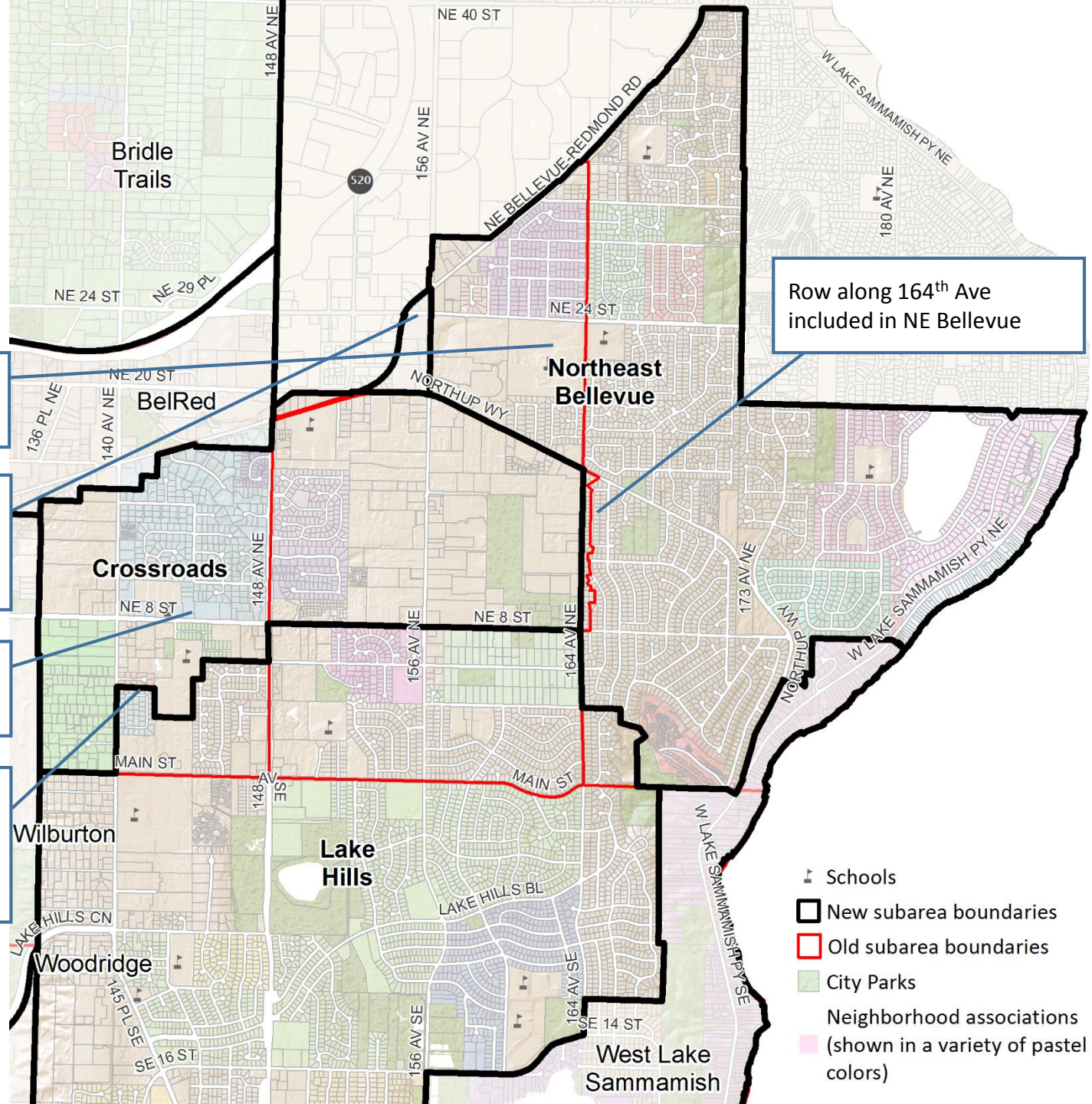

# Lake Hills and West Lake Sammamish

Lake Hills expanded north to follow elementary school attendance area

Lake Hills expanded south to include residential area

Light industrial area included in Eastgate rather than Woodridge

Eastgate includes residential and commercial areas that identify as Eastgate

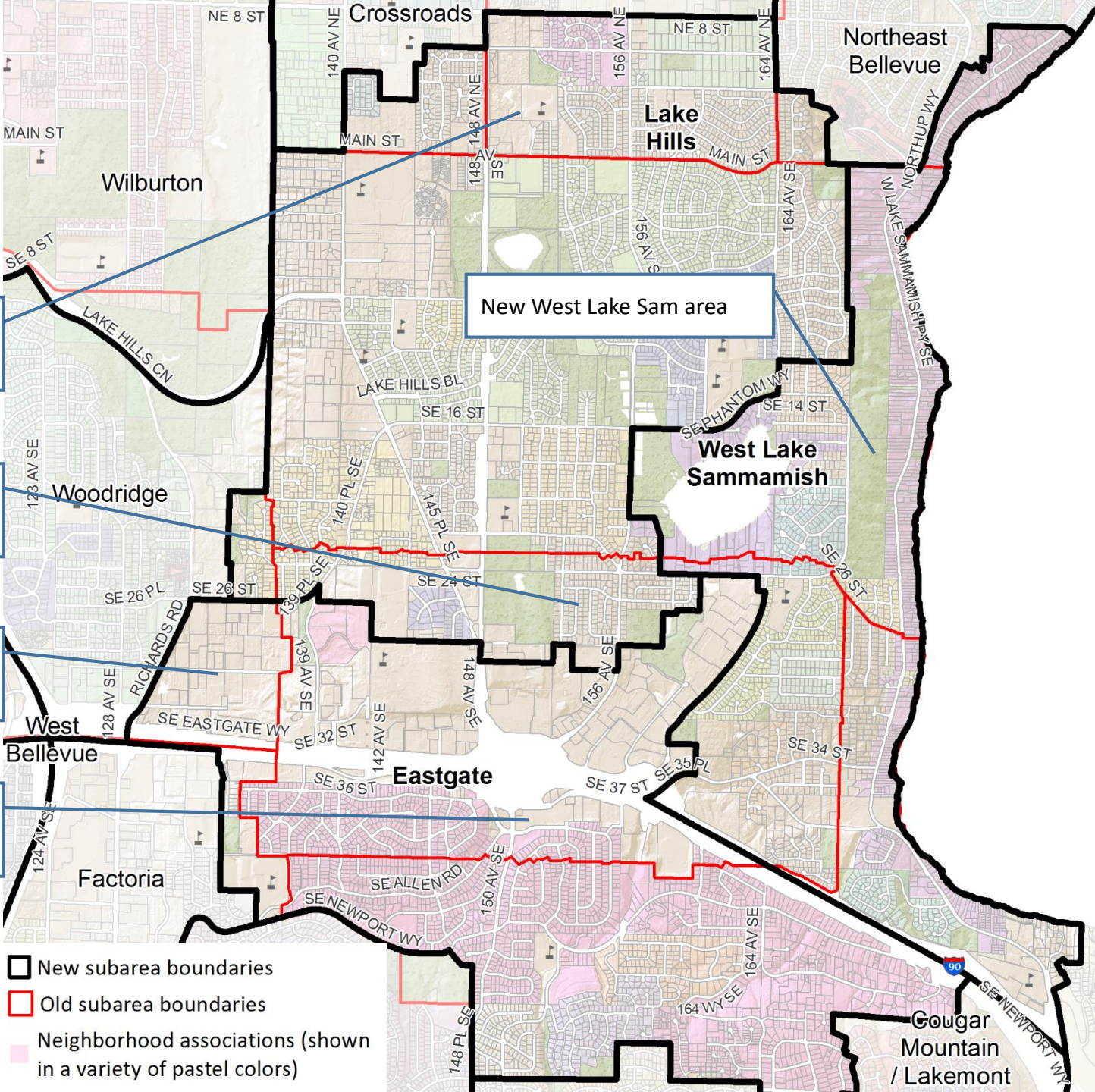

# Eastgate & Cougar Mountain/Lakemont

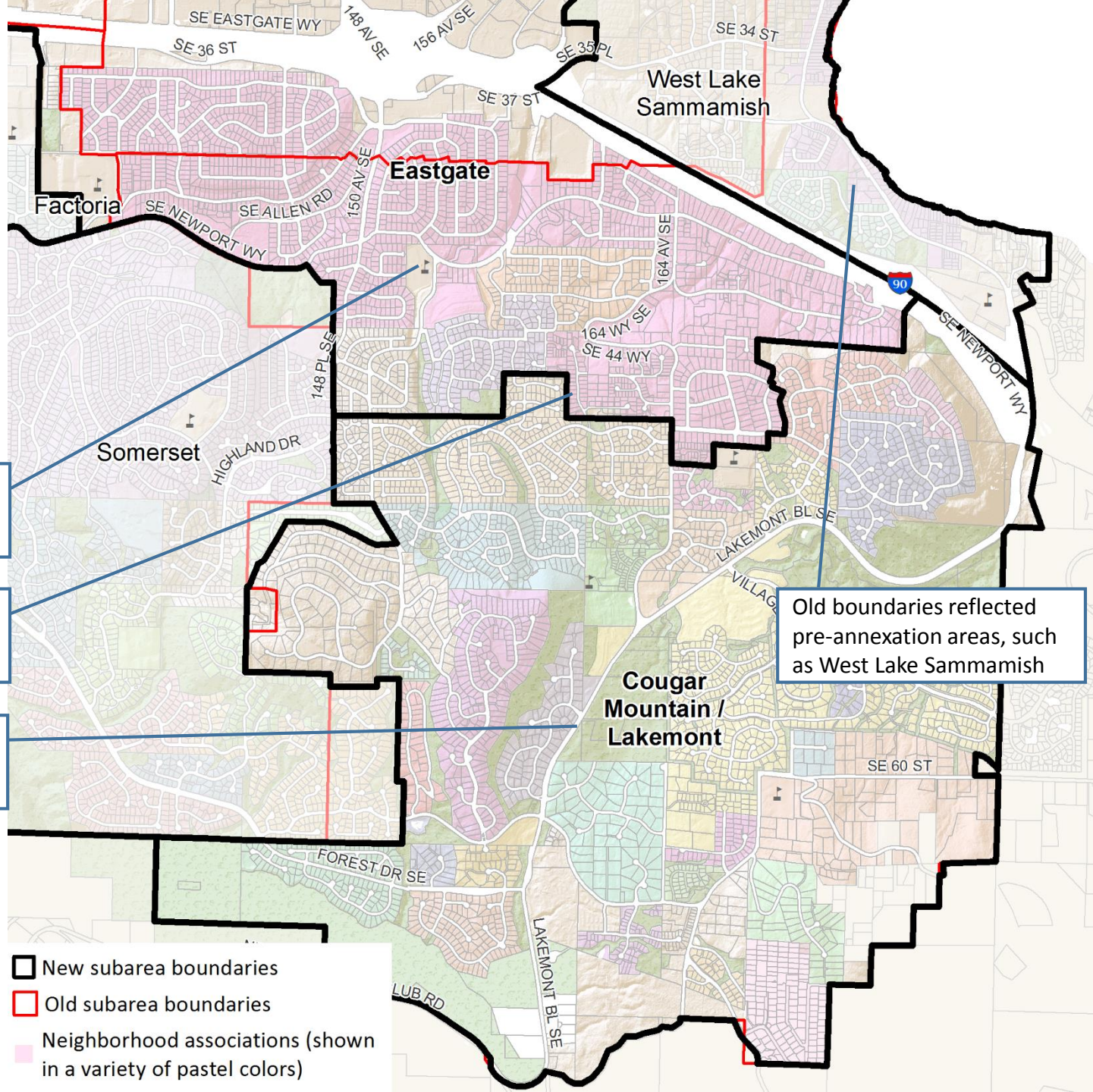

Eastgate includes Eastgate residential neighborhood

Boundary aligned with neighborhood associations and subdivisions

New Cougar Mountain/Lakemont separated from West Lake Sam and Eastgate

Old boundaries reflected pre-annexation areas, such as West Lake Sammamish

- New subarea boundaries
- Old subarea boundaries
- Neighborhood associations (shown in a variety of pastel colors)

# Newport, Factoria & Somerset

Newport Shores, Greenwich Crest, Lake Lanes joined with Newport Hills

New Somerset Neighborhood Area established separate from Factoria

Aligned with Coal Creek Parkway

Boundary aligned with subdivision boundaries

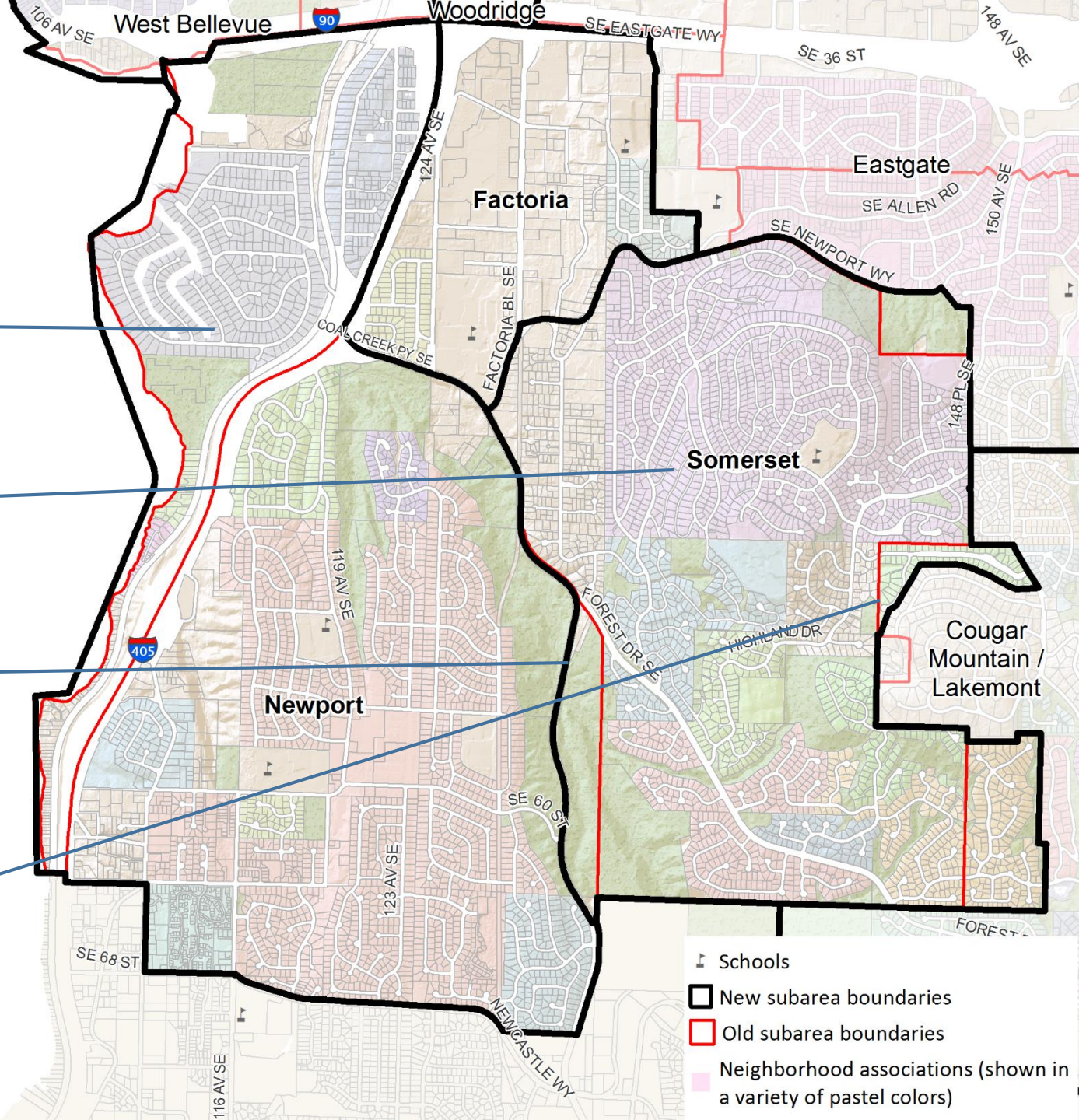

# West Bellevue & Woodridge

- Boundary aligned with Lake Hills Connector
- Boundary aligned with I-405
- Light industrial area included in Eastgate rather than Woodridge

