

Attachment A

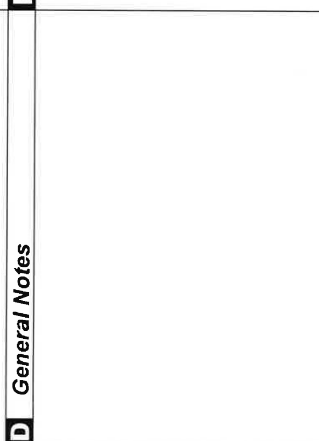

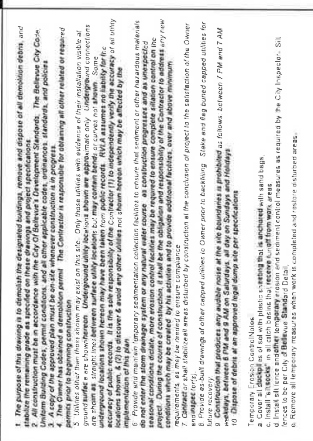
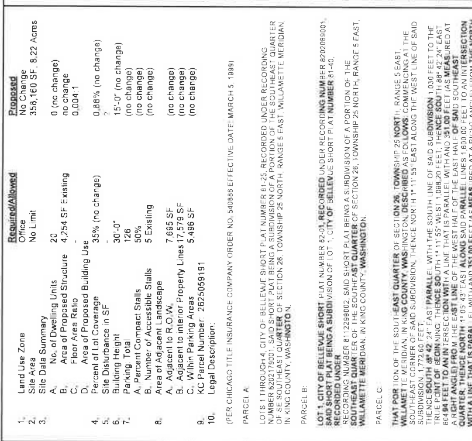
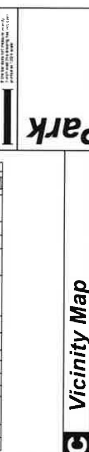
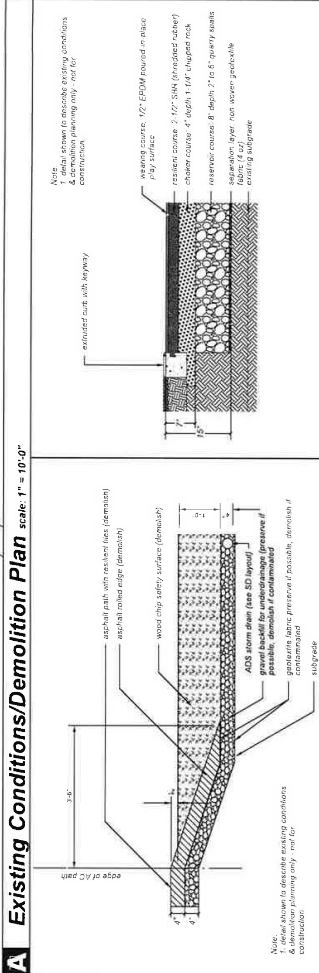
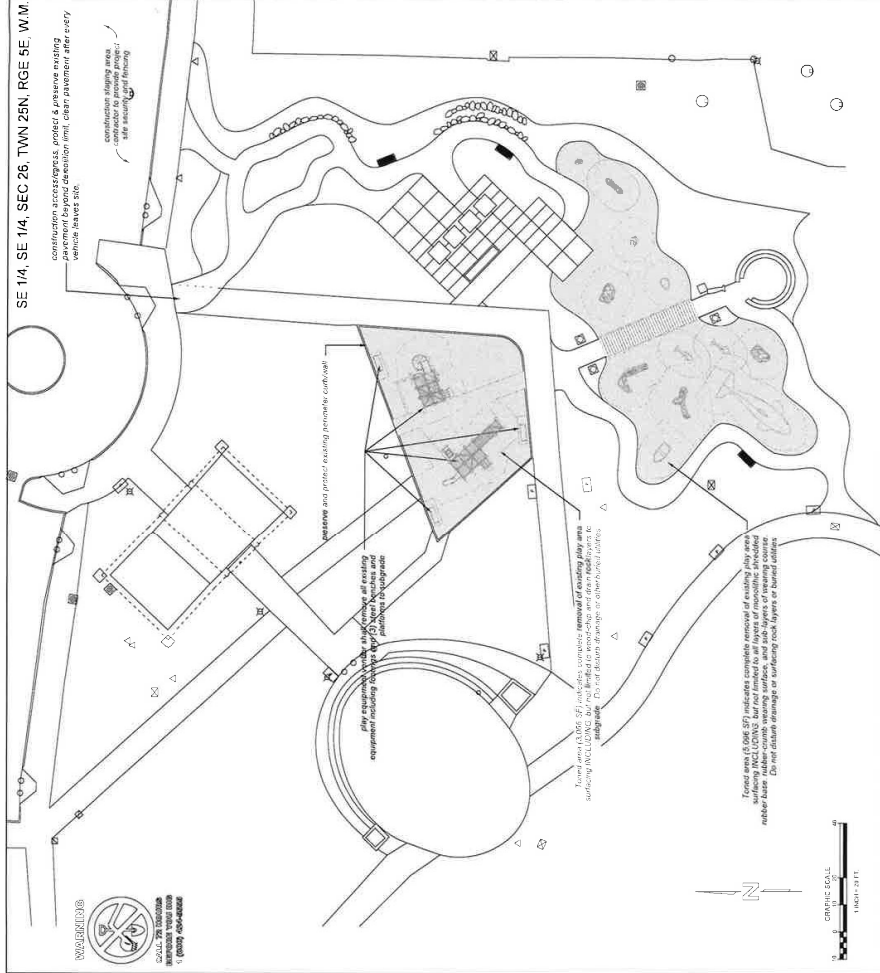
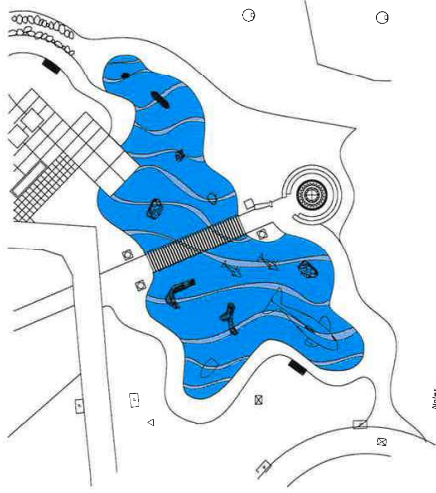

Notes
1 Layout is as designed. Confirm as-built dimensions before producing patterned carpet.

A Striping Layout

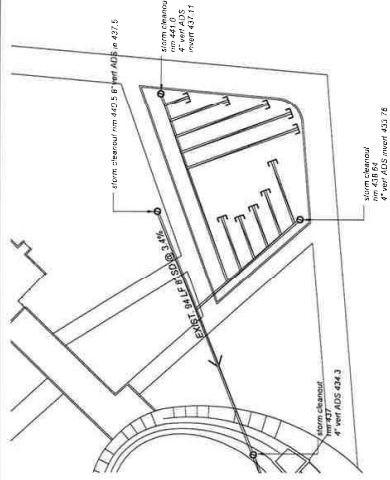

D Existing Drainage scale: 1" = 20'-0"

Existing Spot Elevations scale: 1" = 20'-0"

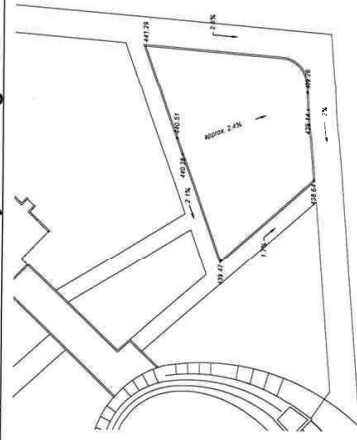

	Synthetic Grass Play Surfacing	no scale
B		

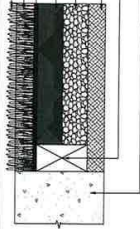

Notes

1. 100% polyethylene grass fiber and secondary trash fiber.
2. Installation to be completed in accordance with Manufacturer's Specifications.



1000000

Altogether, 1000

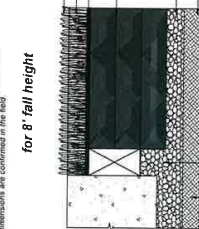

100

1. *What is the main purpose of the study?*

7. 100% polyethylene grass fiber and secondary thatch fiber.

2. Iteration to be completed in accordance with Manufacturer's Specifications
3. All dimensions are confirmed in the field

B	Synthetic Grass
----------	------------------------

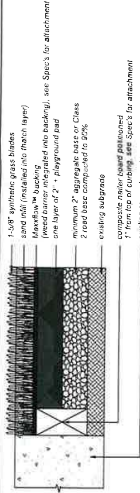

Notes

for 4' fall height

1. 100% polyethylene grass fiber and secondary flitch fiber
2. Installation to be completed in accordance with Manufacturer's Specifications

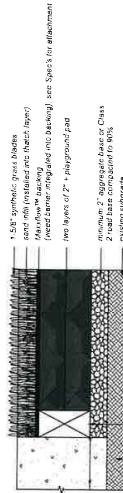

Composite nail board reviewed

* From top of curbing, set Space's for attachment of seeding concrete curbing

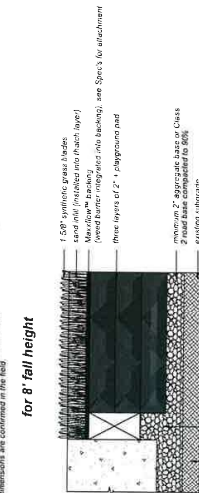

Commissaire général, Grand Nord

existing concrete curbing

† 100% polyethylene grass fiber and secondary hatch fiber.

3. All dimensions are confirmed in the field

	Synthetic Grass Play Surfacing	no scale
B		

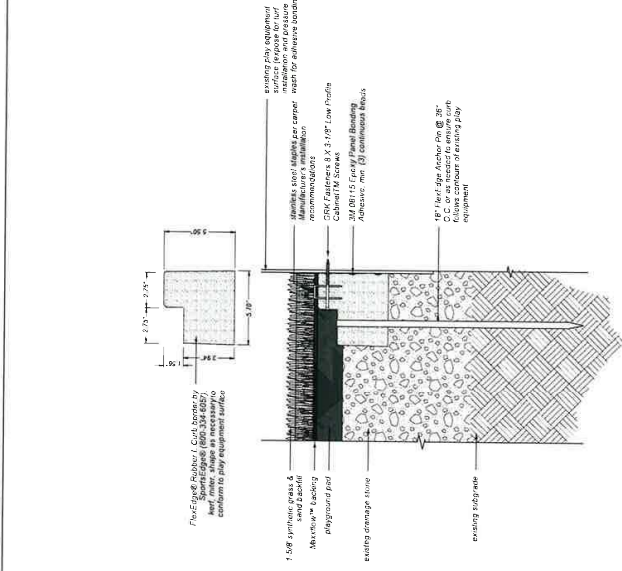

C Synthetic Grass Perimeter at Existing Equin

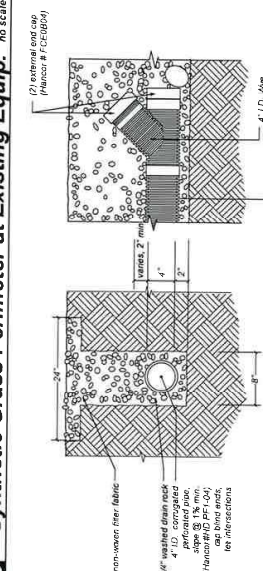

Lateral Section

Collector Clean-out
(see drainage plan for locations)

F New Sub-Surface Drainage