



# Bellevue Grand Connection

Bellevue City Council Update

June 19<sup>th</sup>, 2017

# Tonight's Discussion



- Draft Framework Plan – Vol. 1 - *Sequence One*
  - Contents
  - Structure
  - Timeline
- I-405 Crossing Update
  - Updates to crossing alternatives
  - Process
  - Timeline
    - EIS
    - Framework Plan Vol. 2 – *Sequence Two*

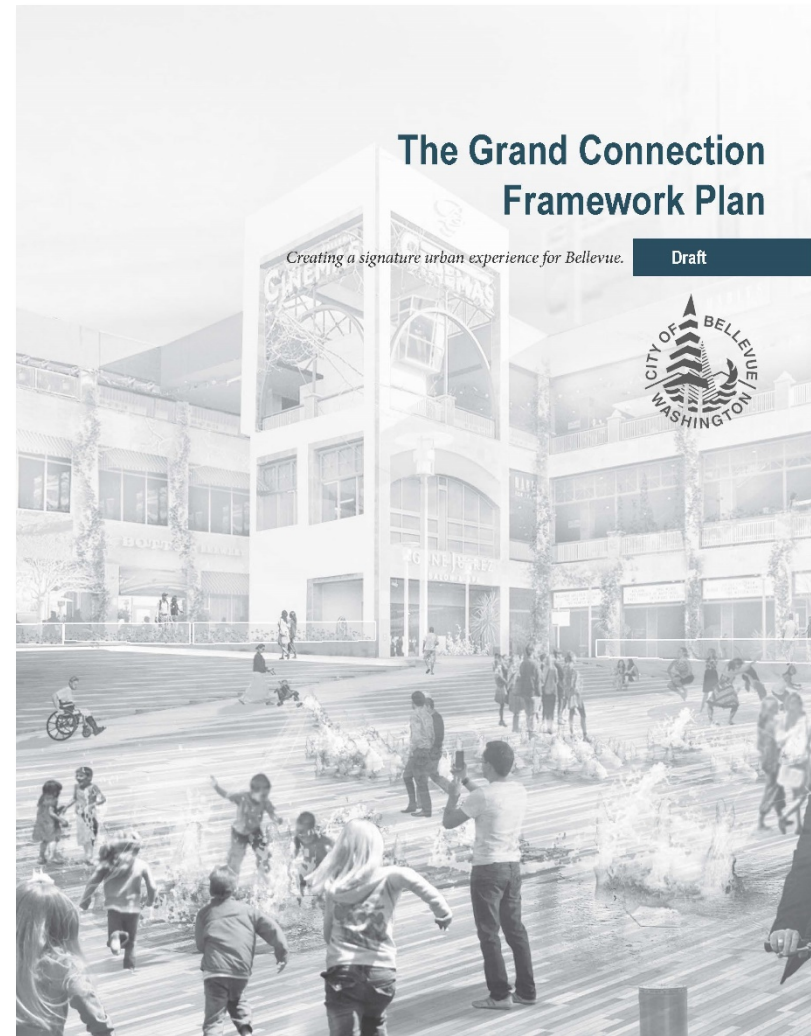

# Where we are

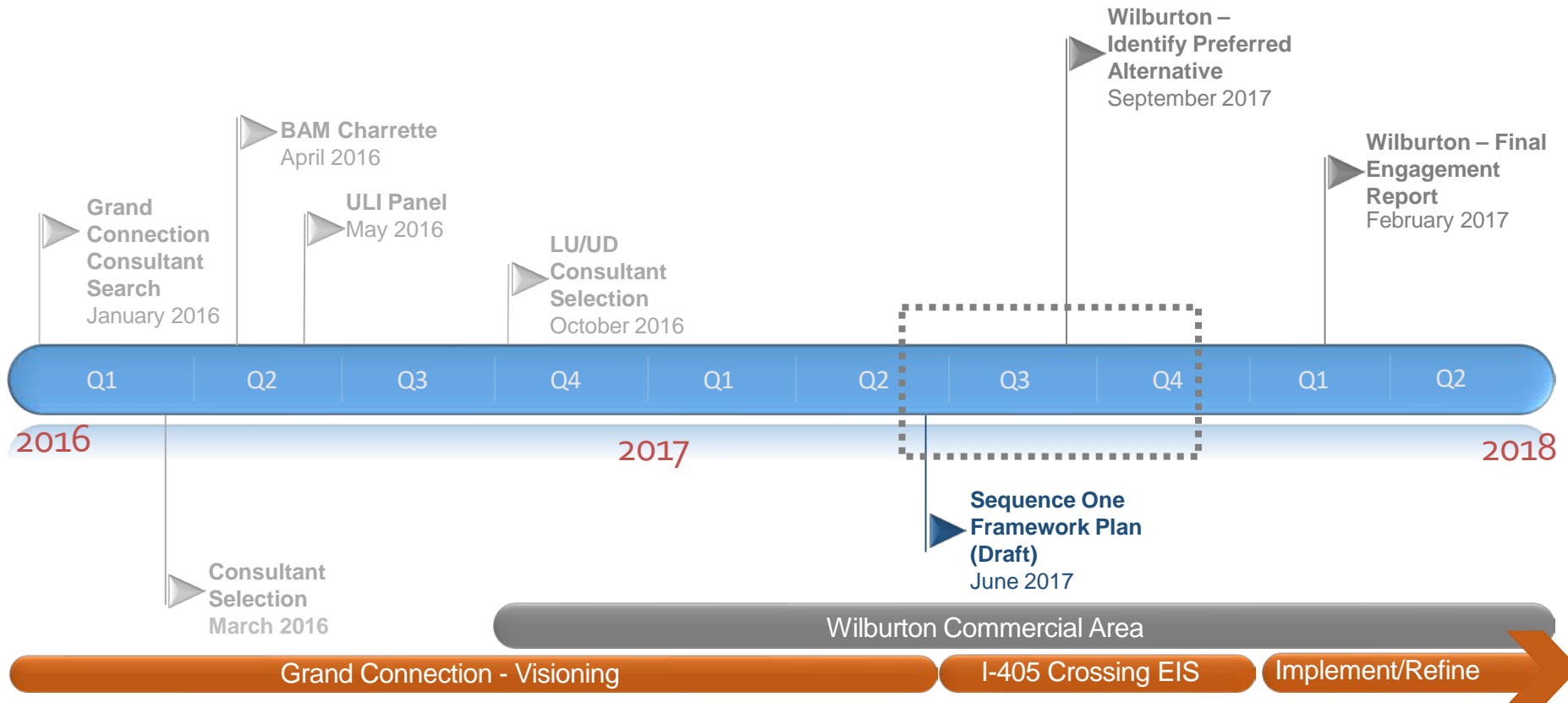

# Sequence of Work

- Visioning
  - Develop a high level conceptual understanding and design of opportunities
- Sequence One
  - Meydenbauer Bay to Civic Center
- Sequence Two
  - Interstate 405 Crossing
  - Interface with:
    - Wilburton Commercial Area
    - Eastside Rail Corridor

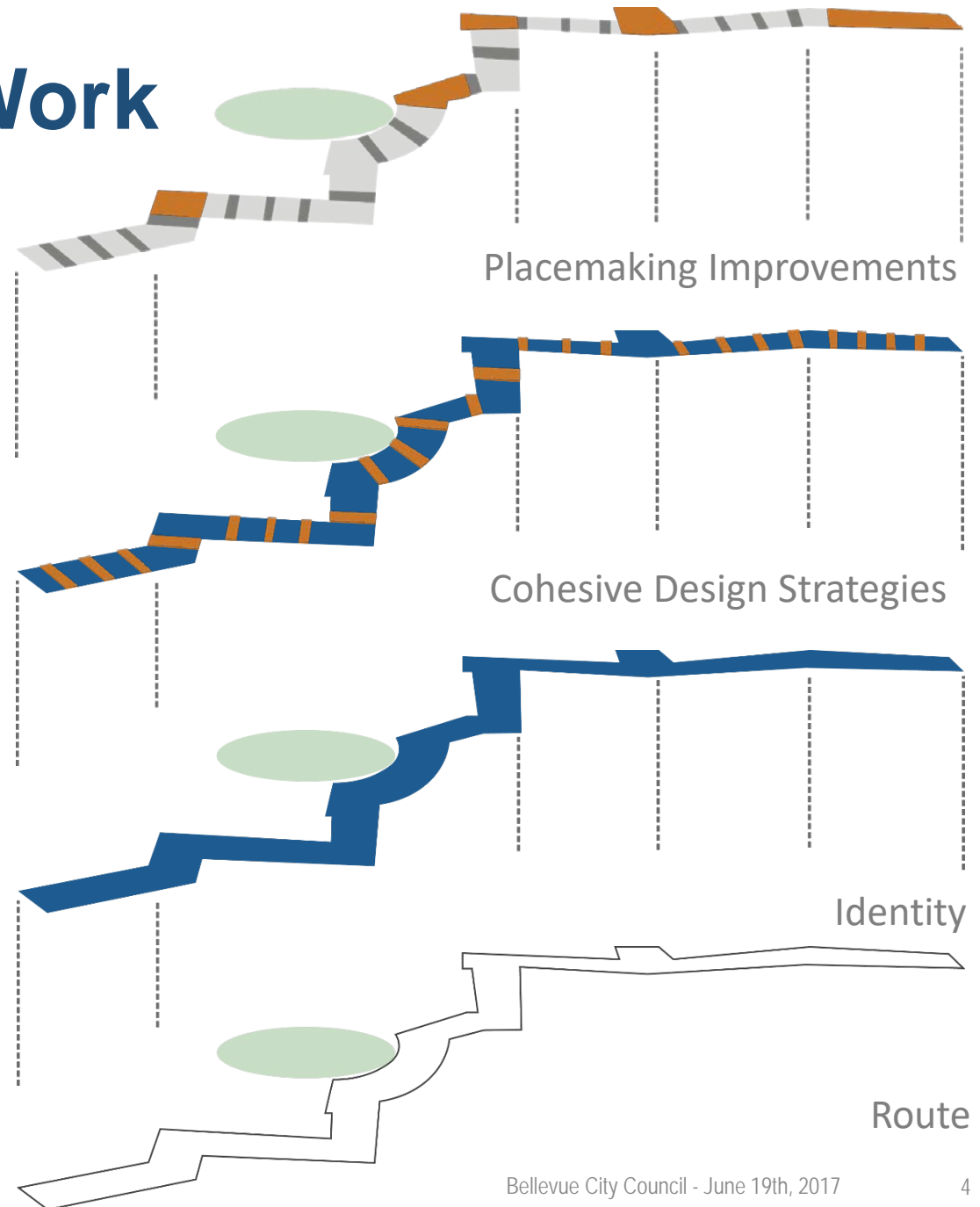



# Where we have been



# Draft Framework Plan



# Draft Framework Plan

## Contents



- Sequence One
  - Meydenbauer Bay to Civic Center
- 11 Chapters
  - Introduction
  - Public Engagement
  - The Route
  - Route Identity
  - Cohesive Design Strategies
  - Art and Culture
  - Connectivity and Mobility
  - Public Spaces
  - I-405 Crossing
    - *Draft*
    - *Information and Context Only*
    - *Subsequent Report – Sequence Two*
  - Programming
  - Implementation and Next Steps

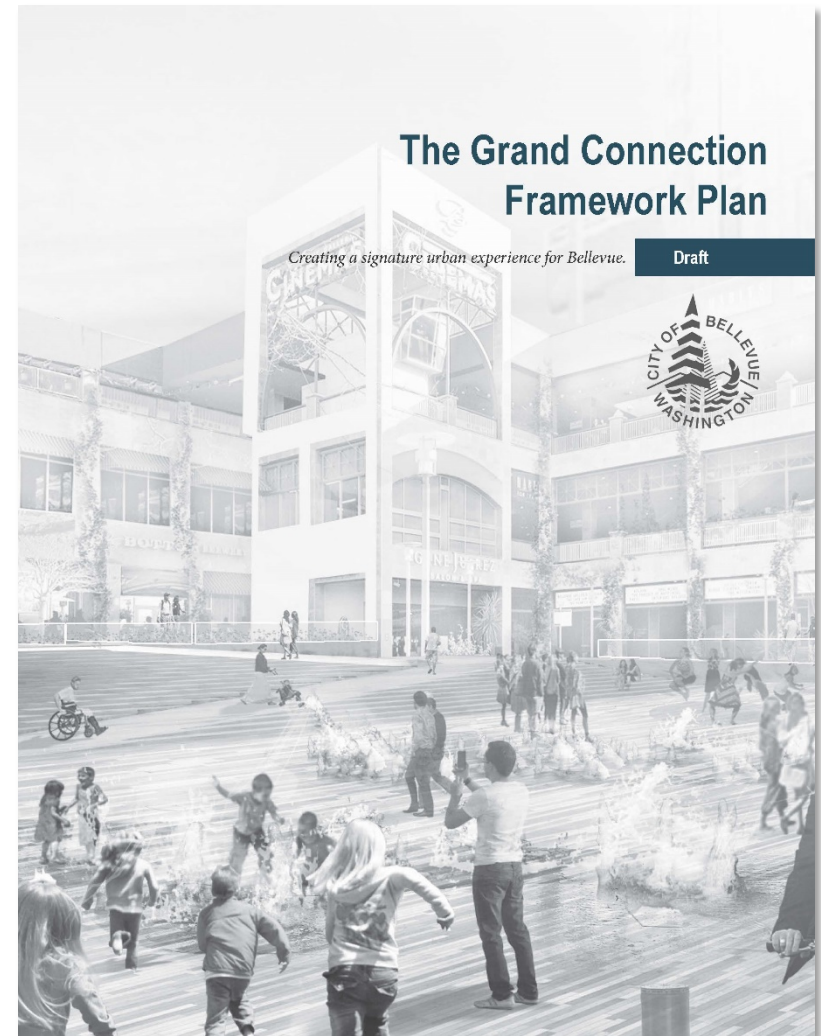

# Draft Framework Plan Structure



## Key Strategy

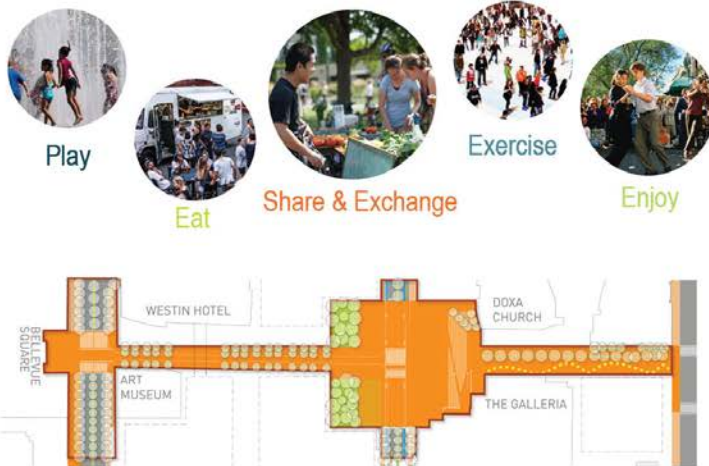

▲ Pedestrian Corridor from Bellevue Way to 108th Avenue NE - Concept. Image by Balmer Associates

## Next Steps: Compass Plaza

- Design refinement and phasing approach for the Compass Plaza reconfiguration, including materials, programming, and art installations.
- Explore the opportunity to expand the plaza to the west as a long-term strategy.
- Explore opportunities to collaborate and partner with private development improvements and City initiatives.
- Engage in tactical urbanism events to test and demonstrate potential future improvements.
- Explore programming and cultural plinth opportunities.

- Post to City and project websites
  - By Chapter
- Presentations to:
  - Boards
  - Commissions
  - Civic Organizations
  - Business and Resident Associations



# Art and Culture



- SuttonBeresCuller
- Grand Connection as a Cultural Corridor
- Ongoing, curate-able corridor for arts
- Identity of neighborhoods and culture
- Programming to enhance the urban experience
- Appendix to the Framework Plan
  - July 11<sup>th</sup>, 2017

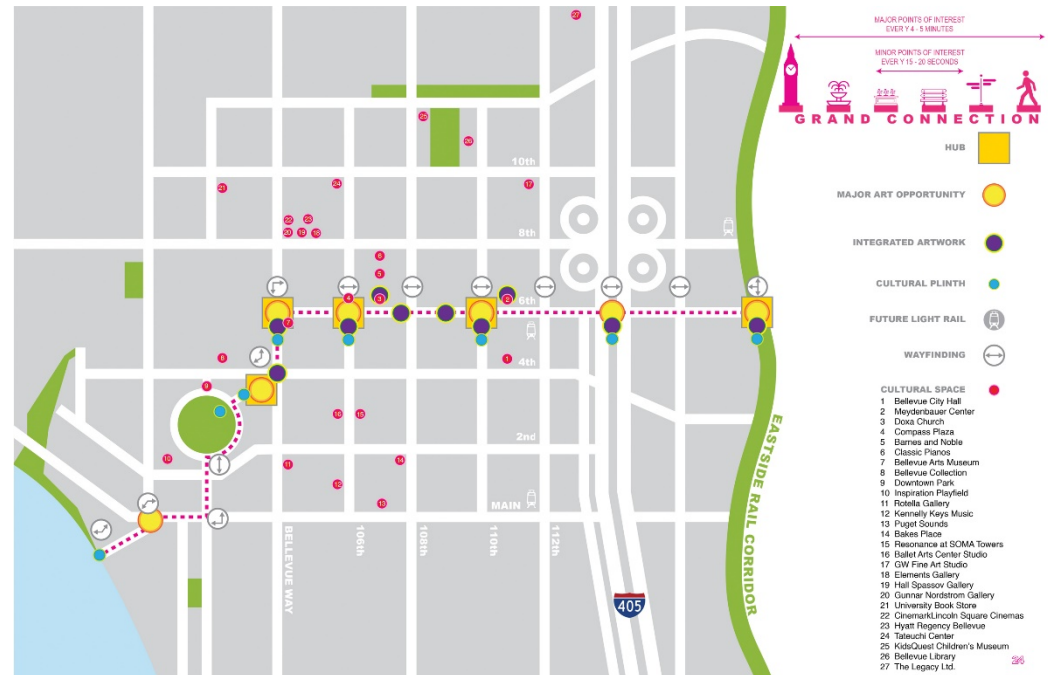

# Art and Culture



- Re-imagine Bellwether
- Cultural Plinths
- Mural Program
- Art Walks
- Small “discoverable” opportunities
- Emerging artists



# Draft Framework Plan

## Process + Timeline



# Interstate 405 Crossing





# Interstate 405 Crossing

## Visioning Goals



- Safe and comfortable connection
- Opportunities for public space
- Integration and cohesion with future development opportunities
- Interface with 116<sup>th</sup> Avenue NE
- Interface with Eastside Rail Corridor
- Signature in form, design & experience

Images removed for copyright issues

# Interstate 405 Crossing

## Alternative One – March 2017

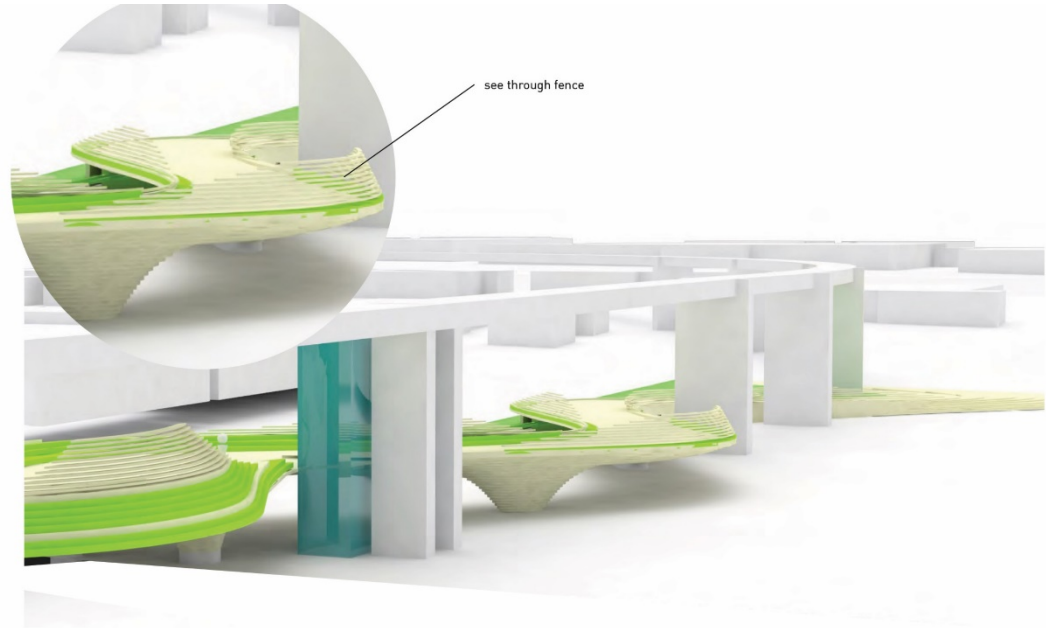
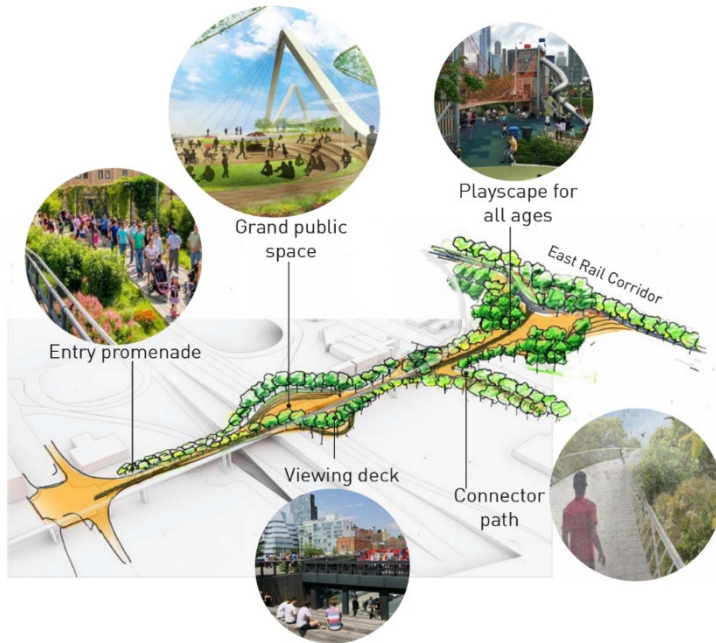

# Interstate 405 Crossing

## Alternative One – Updated









# Interstate 405 Crossing

## Alternative One – Updated



# Interstate 405 Crossing

## Alternative Two – March 2017

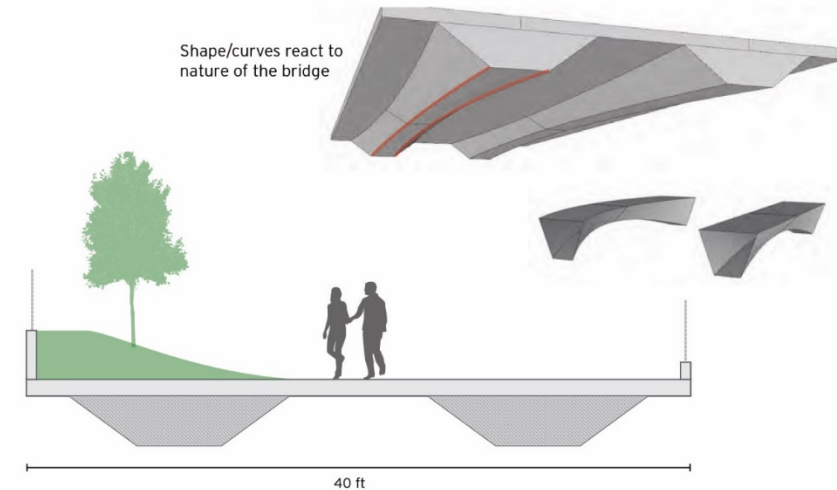
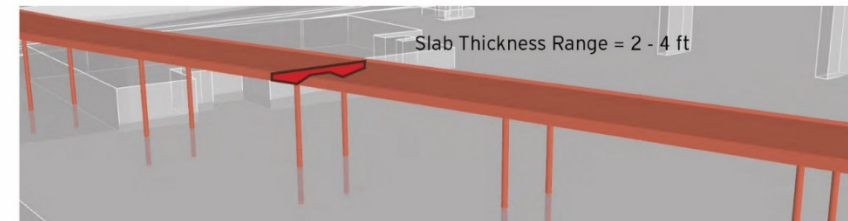
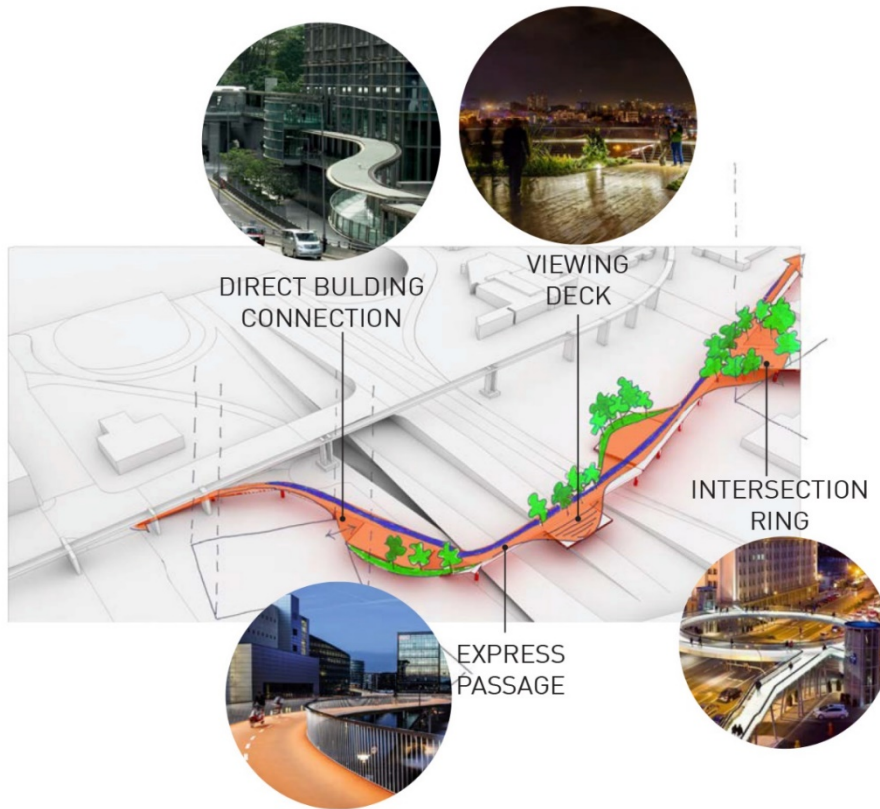



# Interstate 405 Crossing

## Alternative Two – Updated

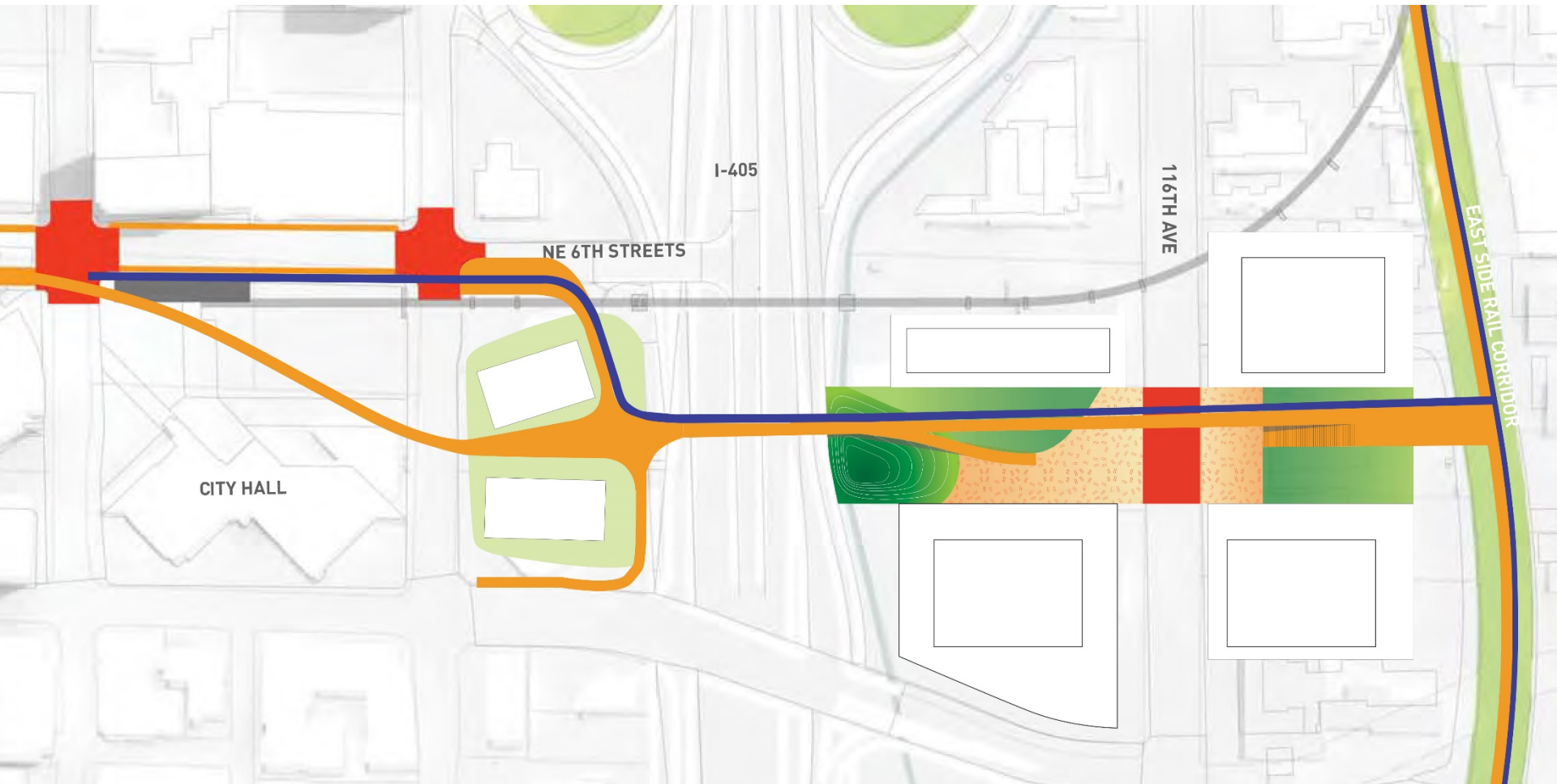





# Interstate 405 Crossing

## Alternative Two – Updated





# Interstate 405 Crossing

## Alternative Three – March 2017

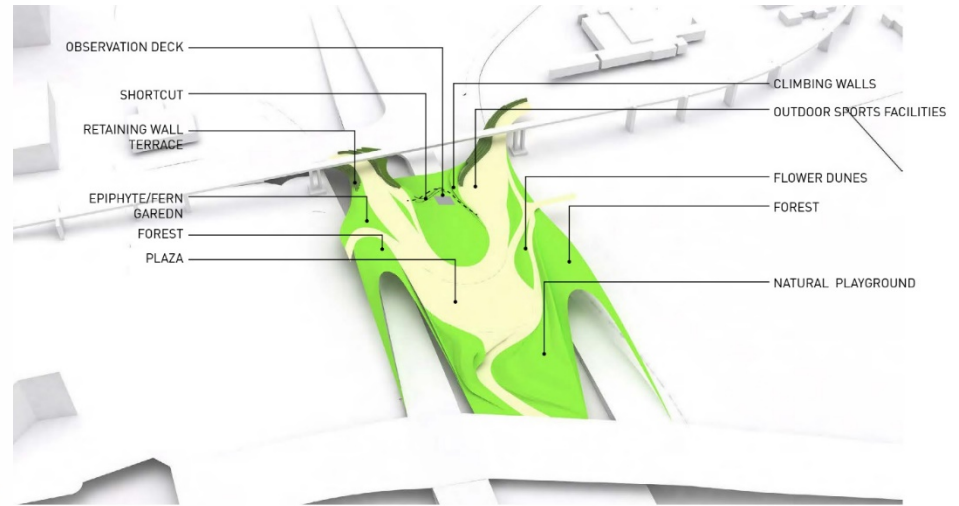

# Interstate 405 Crossing

## Alternative Three – Updated









# Interstate 405 Crossing

## Alternative Three – Updated



# Interstate 405 Crossing

## Process + Timeline



September

- Release of Draft Environmental Impact Statement (DEIS)

September –  
January (2018)

- Draft Framework Plan – *Sequence Two* – Interstate 405 Crossing

Q1 2018

- Environmental Impact Statement





# Questions/Discussion

[www.bellevuegrandconnection.com](http://www.bellevuegrandconnection.com)