

# Bellevue City Council Water System Plan

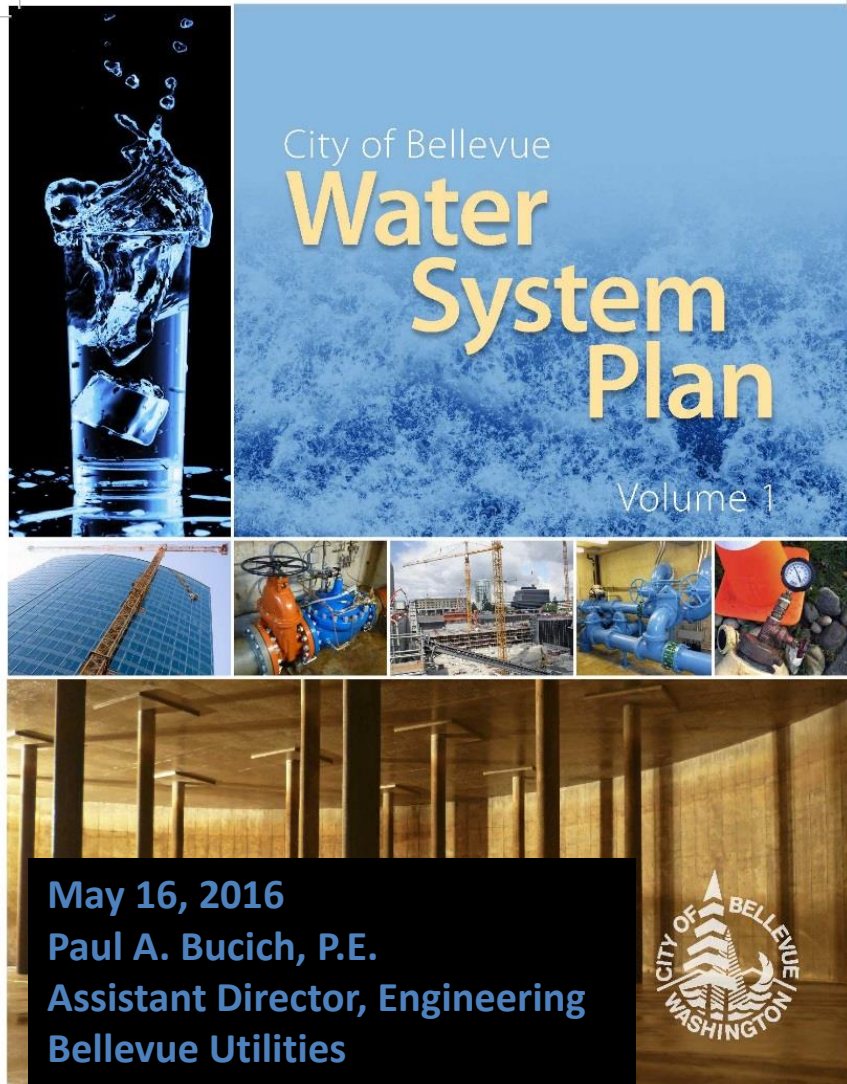

- Agenda:
  - Council Interest Statement
  - Public Review Process
  - The Water System Plan
    - Policies
    - System Evaluation
    - Plan Recommendations
  - Discussion

**May 16, 2016**  
**Paul A. Bucich, P.E.**  
**Assistant Director, Engineering**  
**Bellevue Utilities**



# Bellevue Service Area



- Bellevue, Clyde Hill, Yarrow Point and Hunts Point.
- Kirkland, Issaquah, KC
- Served by SPU
  - Tolt
  - Cedar
- 145,000 residential population

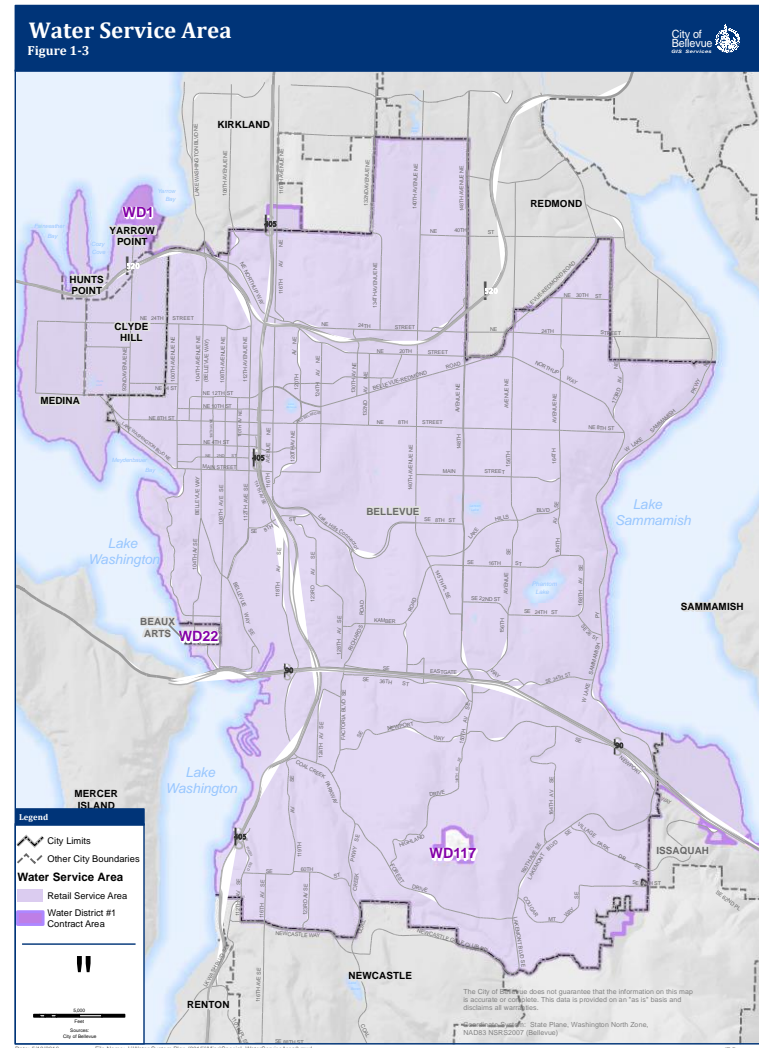

# Council Interest Statement



- Regional Involvement, consistent with Cascade Water Alliance.
- Safe, great tasting, high quality water that meets or exceeds quality standards.
- Reliable and sufficient supply.
- Future-focused, sustainable, environmentally responsible practices.
- Minimized life-cycle costs, managed risk, and consistent service levels.
- Self-supporting, rate stability, competitive fees, inter-generational equity, minimal debt.
- Performance measured and evaluated against industry benchmarks
- Conservation, innovation and the efficient use of water.



# Public Review Process

- Environmental Services Commission
- Neighboring Utilities
- SEPA
  - Public Open House
  - Press & Social Media



# Policies



- **Customer Service**
  - Drinking Water Storage for Emergency Supply Outages
  - Green Buildings
- **Service Area**
- **Regional**
  - Water Rights for Supply Redundancy
  - Regional Policy Development
- **Fire Protection**
- **Water Quality**
- **Facility Abandonment**
  - Facility Repurposing
- **Financial**



# Regional Policy Development



- Guides Bellevue's role in influencing regional decision-making.





# Emergency Storage

- Articulates and formalizes the City's longstanding practice
- 1-day reserve for emergencies, plus fire and daily operational storage
- Independent review confirmed criteria is appropriate and consistent with industry standards



# Water Rights for Supply Redundancy



- Acknowledges our groundwater rights
- Allows for investment and expanded use of wells as emergency supplies
- Supported by Cascade Water Alliance
- Goal is increased resiliency

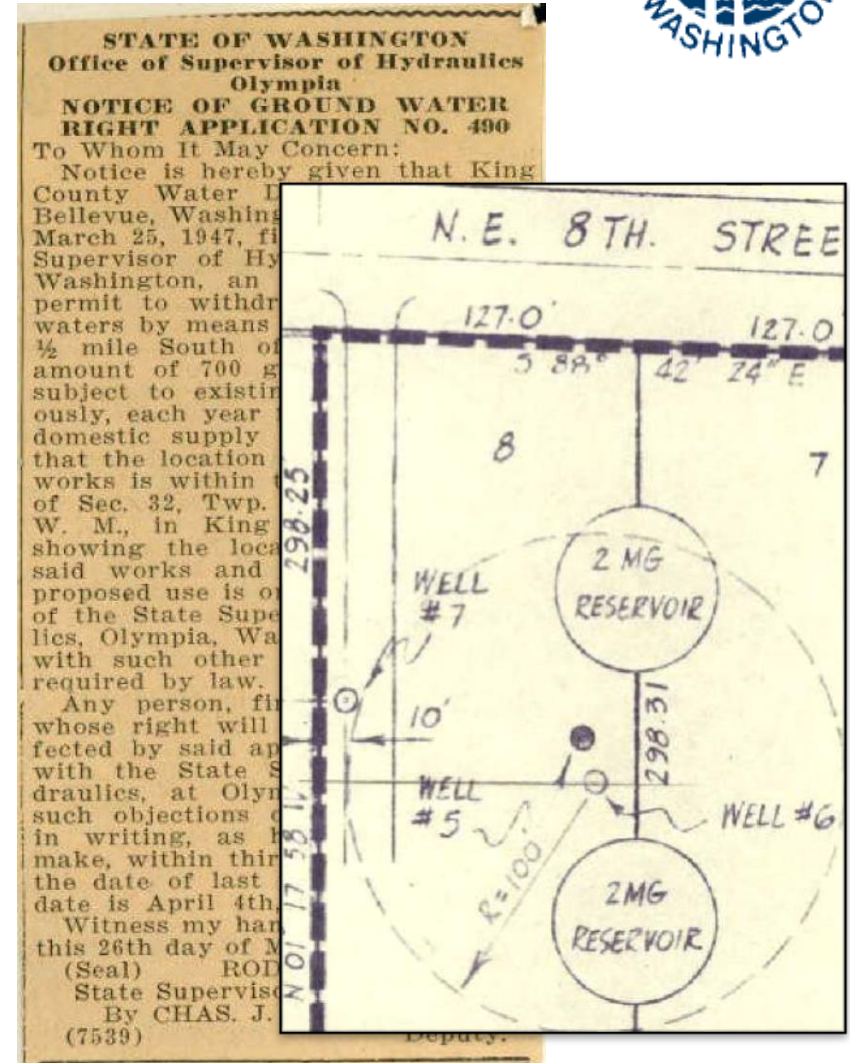



# Facility Repurposing



- Addresses emerging opportunities to generate revenue for the City by repurposing older, unused infrastructure.



# Green Buildings



- Anticipates development of “net-zero” and green, sustainable buildings
- Directs Utility to identify and propose changes to technical requirements and potential policies.
- Ensures equitable treatment of new and existing customers



Bullitt Center (Seattle)

# System Evaluation



- Planning for Growth
- Water Conservation
- Emergency Preparedness

# Planning for Growth

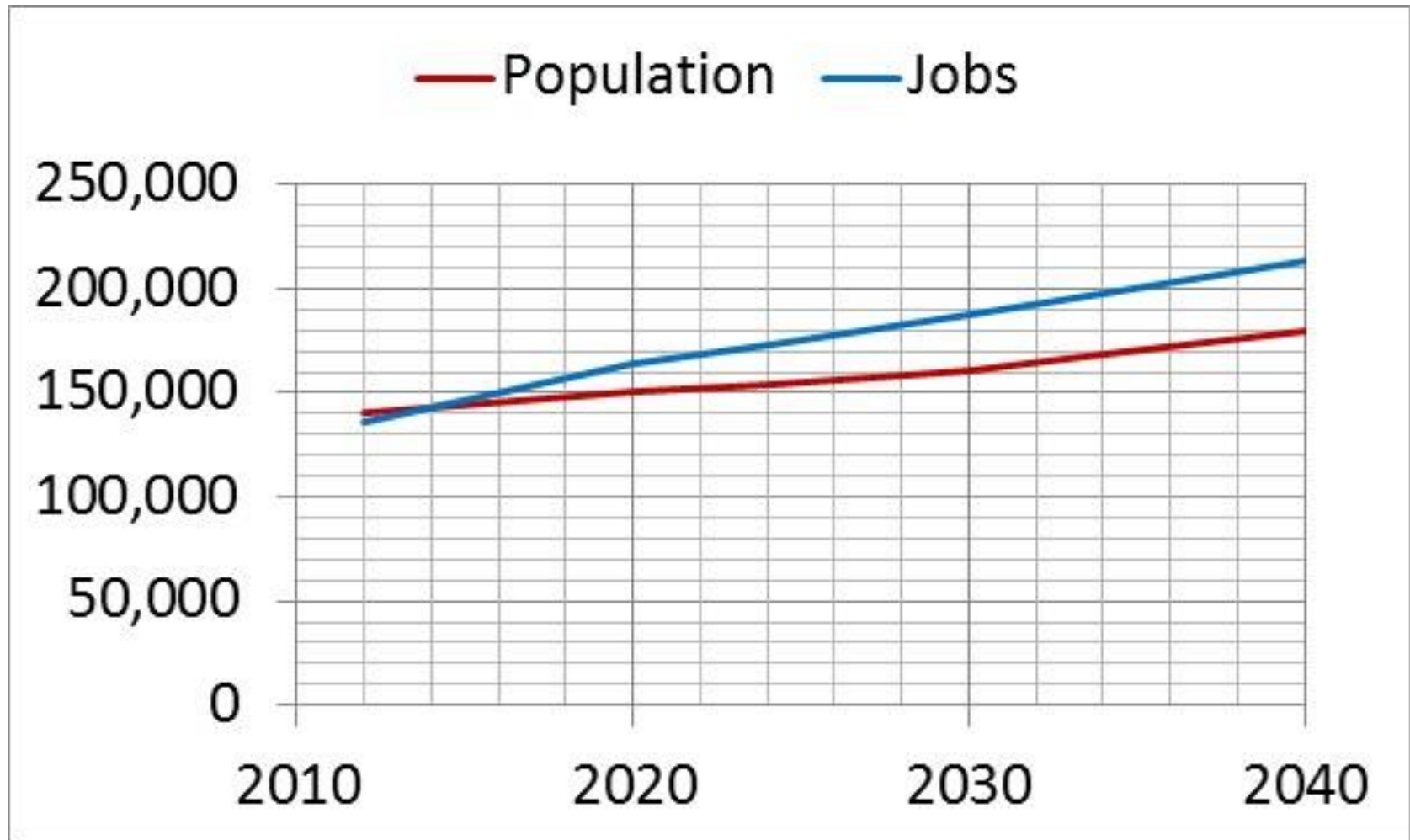



# Water Conservation

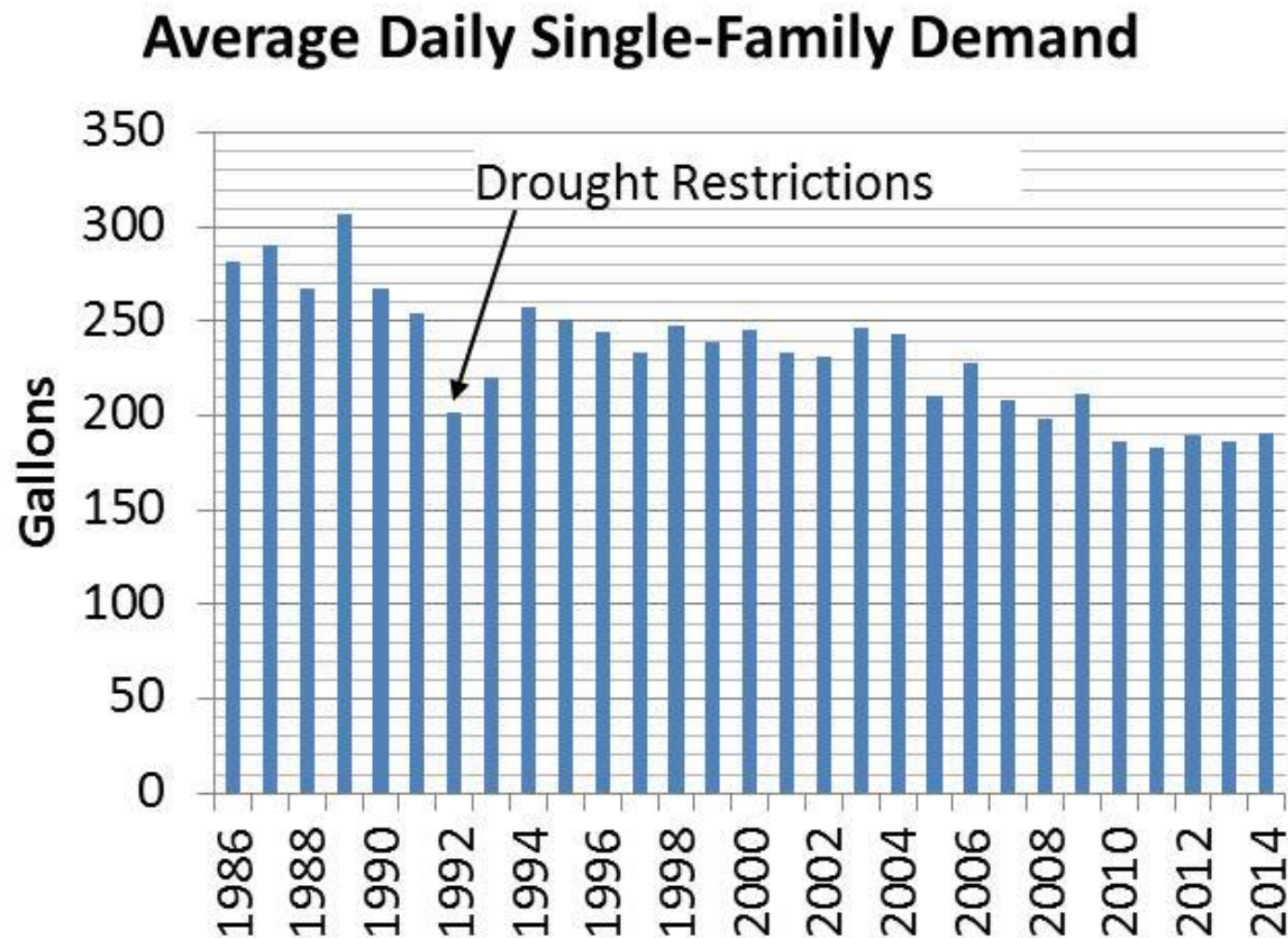



# System Resiliency/Emergency Preparedness



- Emergency Management Plan
- Reservoir Seismic Rehabilitation
- Understanding of Distribution System Impacts
  - Locations, types of pipeline failures
  - Customer impacts
  - Time to restore service following event
- No Backup Supply



# Plan Recommendations

- Continue to protect water quality
- Resolve localized system deficiencies
- Growth Projects:
  - New Inlet Station
  - Storage Optimization
- Asset management strategies for rehabilitation and replacement
- Develop master plan to optimize water rights
- Perform seismic vulnerability analysis.





# Water System Plan Status

- Plan development is complete
- Public and regulatory reviews conducted
- City Council adoption May/June 2016
- County Council adoption Summer/Fall 2016
- Final approval by WA Dept of Health (2016 or 2017)

# Discussion

