

PW-R-166 124th Ave NE-Spring Blvd to Ichigo Way (NE 18th)

Category: **Transportation and Mobility**
 Department: **Transportation**

Status: **Approved Prior**
 Location: **124th Ave NE - NE Spring Blvd to Ichigo Way**

Programmed Expenditures

<u>Programmed Expenditures</u>	<u>Appropriated To Date</u>	<u>FY 2021 Budget</u>	<u>FY 2022 Budget</u>	<u>FY 2023 Budget</u>	<u>FY 2024 Budget</u>	<u>FY 2025 Budget</u>	<u>FY 2026 Budget</u>	<u>FY 2027 Budget</u>
28,445,235	28,445,235	-	-	-	-	-	-	-

Description and Scope

This project completes the final design, right of way acquisition, and construction of 124th Avenue NE from NE Spring Blvd. to Ichigo Way (NE 18th Street). This project will widen and raise 124th Avenue NE roadway from NE Spring Blvd. to Ichigo Way (formerly NE 18th Street) to accommodate the Sound Transit East Link light rail line (LRT) crossing under 124th Avenue NE. The widened roadway cross-section will consist of five lanes, two travel lanes in each direction with turn pockets or a center turn lane, curb, gutter and sidewalks on the eastside for the entire project, and on the west side from NE Spring Boulevard to NE 16th Street. The project will also include planter areas, a bridge structure, retaining walls, illumination, landscaping, irrigation, storm drainage, water quality treatment, and install a new signal at NE 16th Street. The project will reflect BelRed urban design criteria and include new and/or relocation of utility infrastructure. Implementation will be coordinated with private development in the vicinity and the development of 124th Avenue NE - NE 12th Street to NE Spring Blvd. (PW-R-169); 124th Avenue NE - Ichigo Way to Northup Way (PW-R-191); and, the NE Spring Blvd. Zone 2, 120th Avenue NE to 124th Avenue NE projects.

Rationale

This project is one of a number of high priority transportation investments that will improve access, circulation, and mobility options for passenger cars, transit, freight, pedestrians, and bicycles to and between Downtown Bellevue, Wilburton, the new BelRed transit-oriented development nodes, and the larger City and region. In coordination with the extension of NE 4th Street, a widened and realigned 120th Avenue NE corridor, the planned NE 6th Street extension, and the new NE Spring Blvd. multi-modal corridor have been associated and advanced as part of the BelRed Plan. The package of projects was formed to address growth, accommodate planned new land use development in the vicinity, and to ensure coordinated design and implementation with the ST East Link project.

Environmental Impacts

Consistent with state and federal environmental requirements, this project has obtained SEPA and NEPA environmental approvals for the full 124th Avenue NE corridor between NE 8th Street and Northup Way. A citywide programmatic environmental review including this project was conducted as part of the citywide 2013-2024 Transportation Facilities Plan (TFP) update. Programmatic impact and mitigation documentation is included in the TFP Final Environmental Impact Statement (July 2013).

Operating Budget Impacts

Operating costs will increase due to added street lighting/signal (electricity) and the maintenance of the roadway and landscaping. An estimated \$50,000 will be required to fund these costs adjusted for inflation annually.

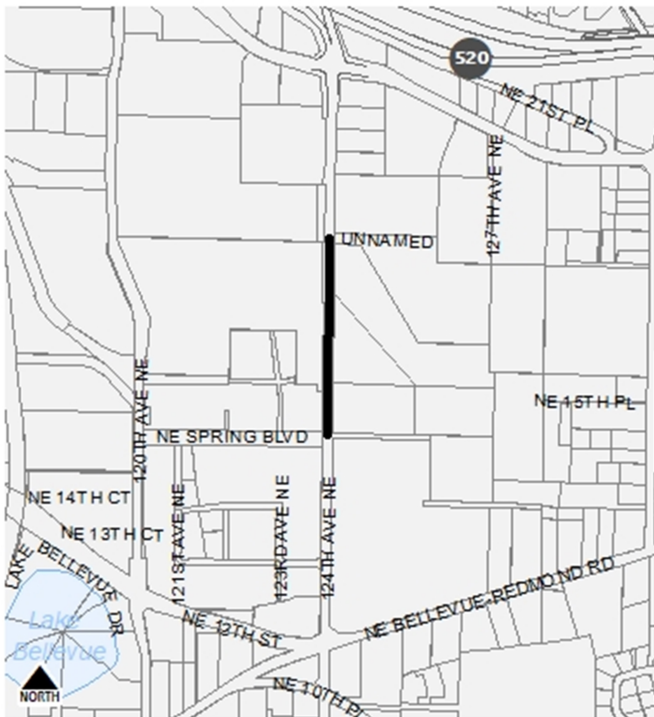
Project Map**Schedule of Activities**

<u>Project Activities</u>	<u>From - To</u>	<u>Amount</u>
Project Costs	2011 - 2021	28,445,235

Total Budgetary Cost Estimate: 28,445,235

Means of Financing

<u>Funding Source</u>	<u>Amount</u>
General Taxes & LTGO Bond Proceeds	2,070,869
Private Contributions	11,956,000
Real Estate Excise Tax	3,403,557
State Grants	6,752,000
Transportation Funding	50,000
Transportation Impact Fees	4,212,809

Total Programmed Funding: 28,445,235
Future Funding Requirements: 0

Comments